

QuickZip™ MAX Straight Display

ASSEMBLY INSTRUCTIONS

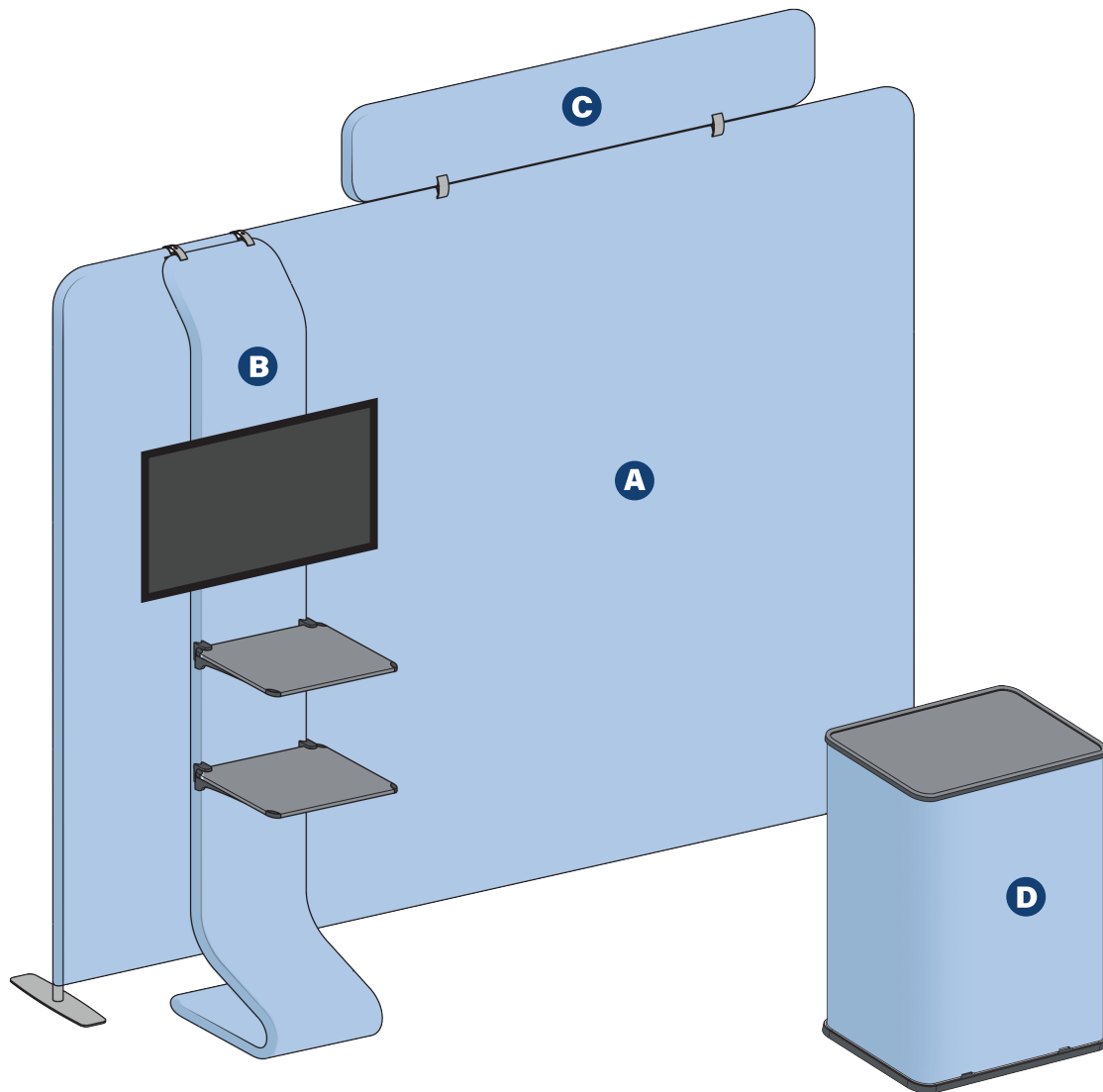

INCLUDED:

- A** QuickZip™ Straight Display
- B** QuickZip™ Waterfall
- C** QuickZip™ Header
- D** Hardcase Podium

A QuickZip™ Straight Display

ASSEMBLY INSTRUCTIONS

BOX CONTENTS

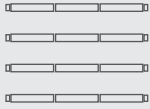

(4) Connected Poles



(2) Bottom Corners



(2) Top Corners

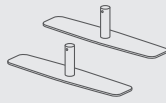

(2) Support Feet



(2) Light Clips

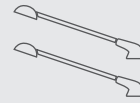

(2) LED Lights
(Optional)



(1) Backdrop Graphic
(Ships Separately)

1

Assemble the Frame

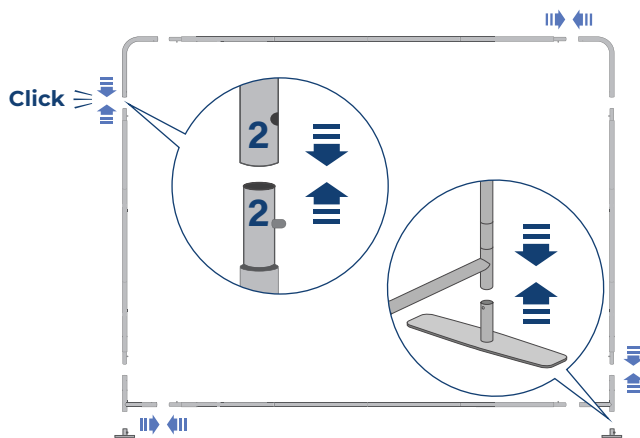

2

Install the Graphic

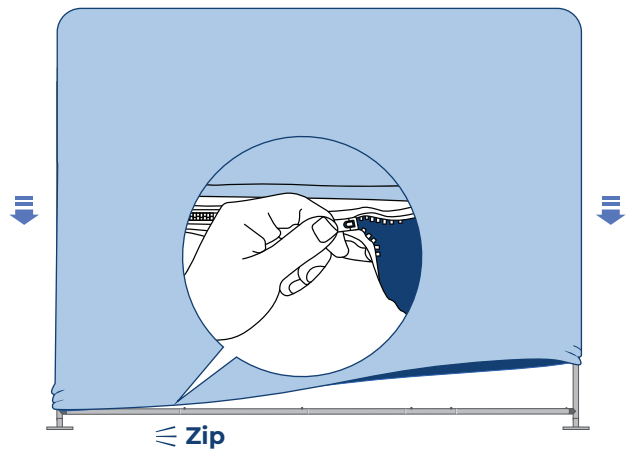

3

Attach LED Lights (Optional)

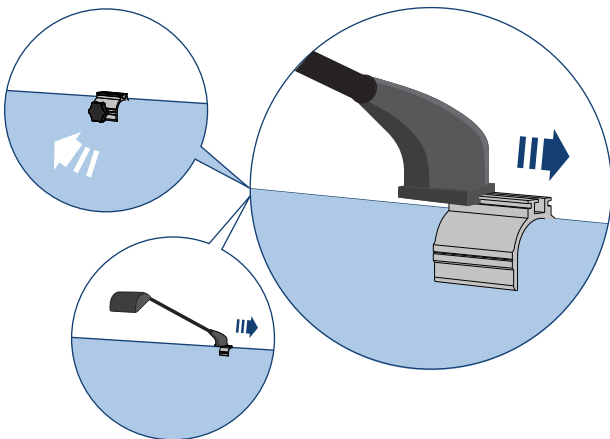

To avoid damage, do not twist the knobs too tight.

4

Align the Display

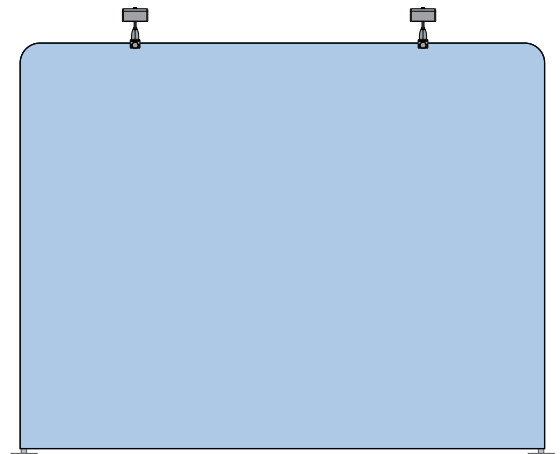

The poles can be maneuvered to stand upright if the frame is leaning



QuickZip™ Waterfall

ASSEMBLY INSTRUCTIONS

BOX CONTENTS



(2) Waterfall Clamps



(4) Shelf Screws



(2) Connected Poles



(2) Shelves



(3) Crossbars



(4) Shelf Brackets



(2) End Poles



(1) TV Stand Graphic
(Ships Separately)



(2) Corner Poles

BOX CONTENTS - TV MOUNT



(1) TV Mount
Main Support



(2) TV Mount
Brackets



(8) M5/M6
Washers



(4) M6 x 24mm
Screws



(4) M5 x 24mm
Screws



(2) M5 x 35mm
Screws

NOT FOR USE WITH DISPLAY



(4) Wall Anchors



(4) Wall Anchor
Screws



(4) Spacers

1

Assemble the Frame

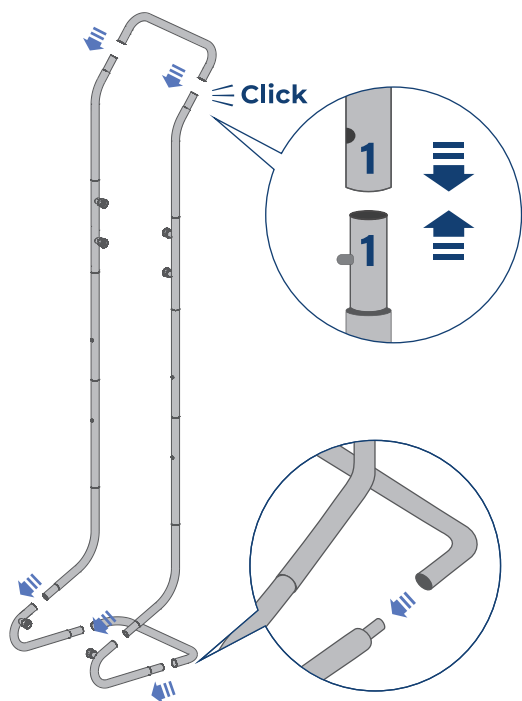

2

Connect the Crossbars

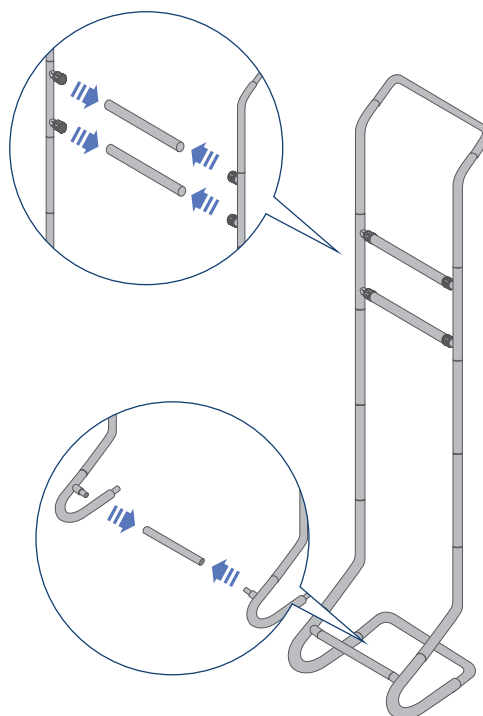

3

Install the Graphic

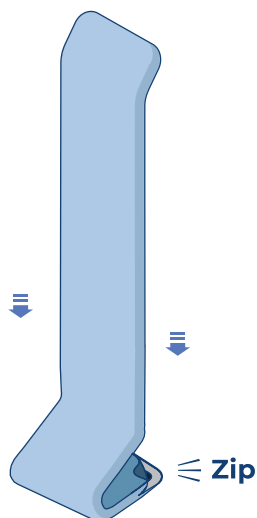

4

Attach to Backdrop

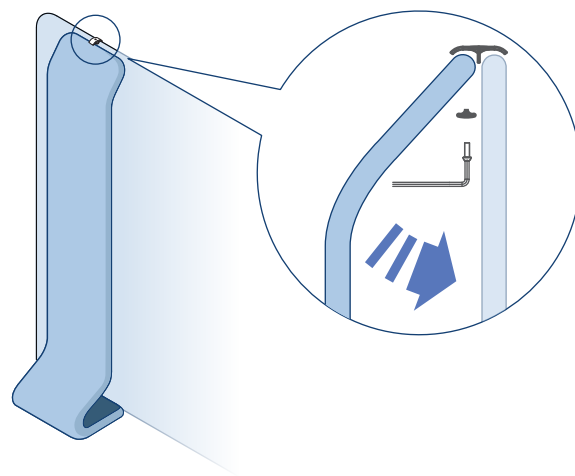

5

Attach TV mount

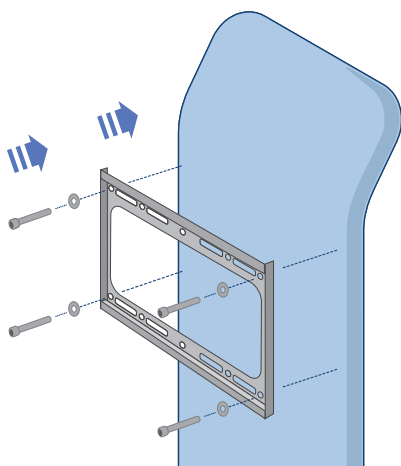

Screw the TV Mount on the display using the M6 Screws and M6 washers.

6

Attach Brackets to Monitor

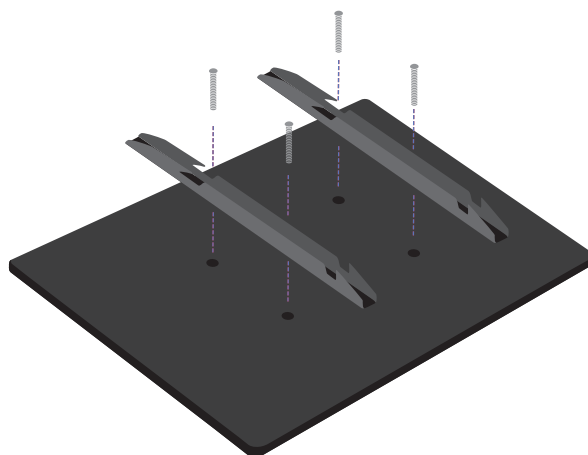

Use the M5 x 24mm screws.

7

Install Shelves

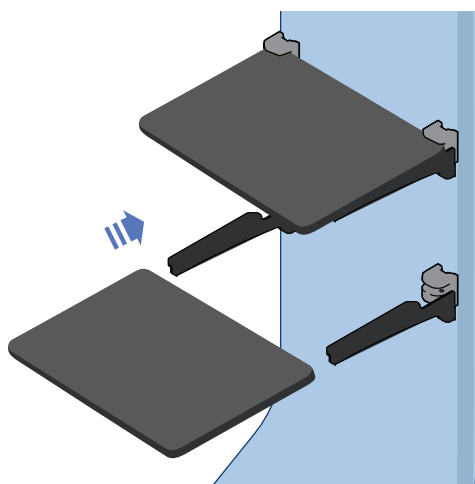

8

Mount the Monitor

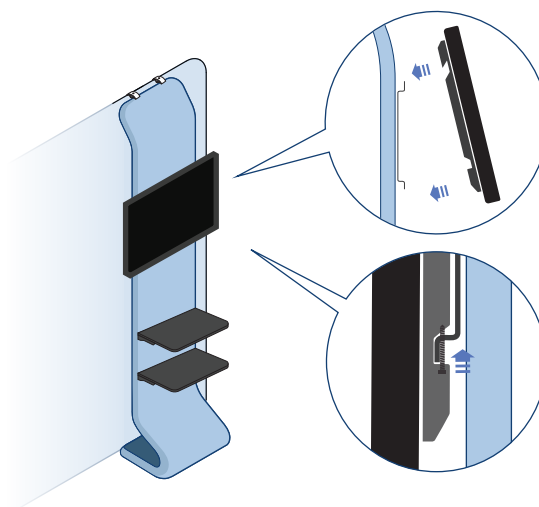



QuickZip™ Straight Header

ASSEMBLY INSTRUCTIONS

BOX CONTENTS

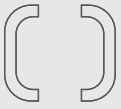

(2) Curved Poles

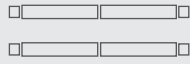

(2) Connected Poles



(2) Header Clamps



(1) Allen Key



(1) Header Graphic
(Ships Separately)

1

Assemble the Frame

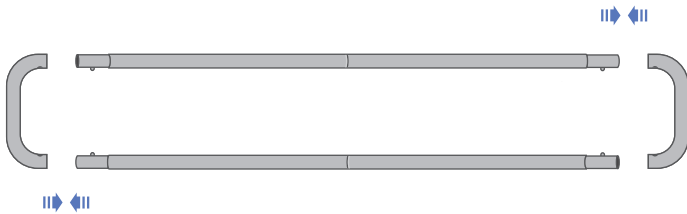

2

Install the Graphic

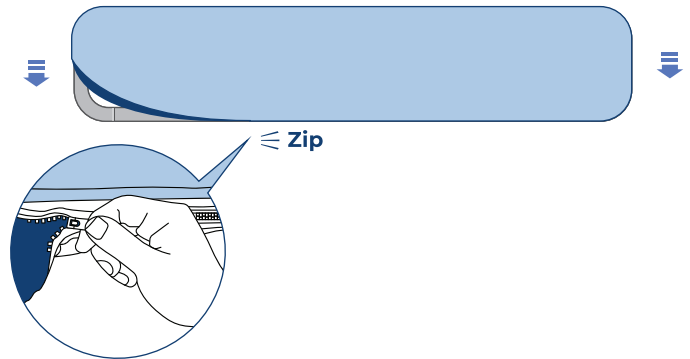

3

Attach Header to Backdrop

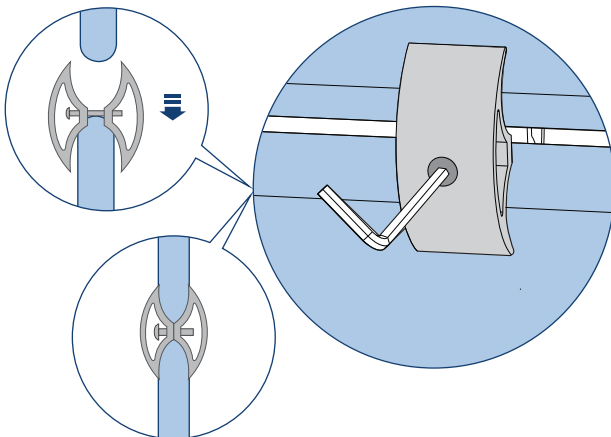

4

Align the Display

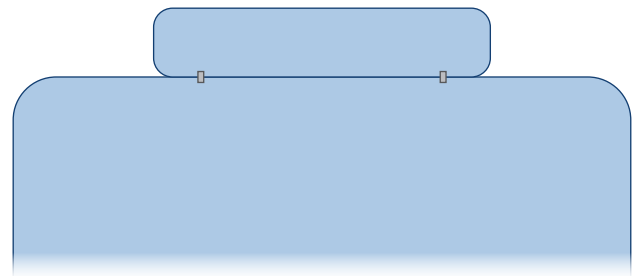

Tighten the clamps with the allen key to secure the header in place.



Hardcase / Podium

ASSEMBLY INSTRUCTIONS

BOX CONTENTS

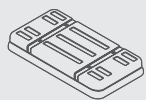

(1) Case Lid

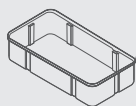

(1) Storage Case



(1) Counter Top

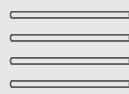

(4) Poles



(1) Podium Graphic
(Ships Separately)

1

Prepare the Base

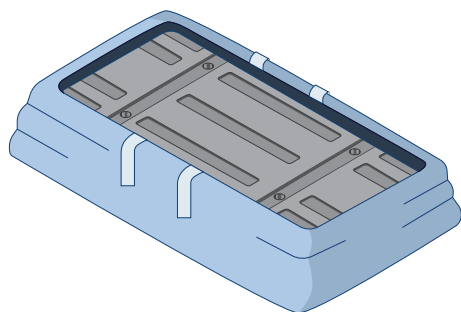

Tuck the bottom end of the Graphic under the Case Lid

2

Set Up the Hardware

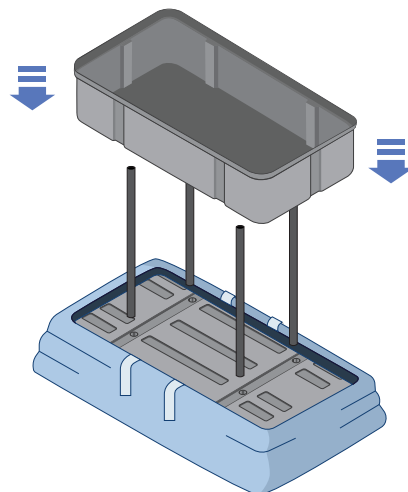

Install the Poles into the Case Lid, then install the Storage Case.

3

Pull Up Graphics

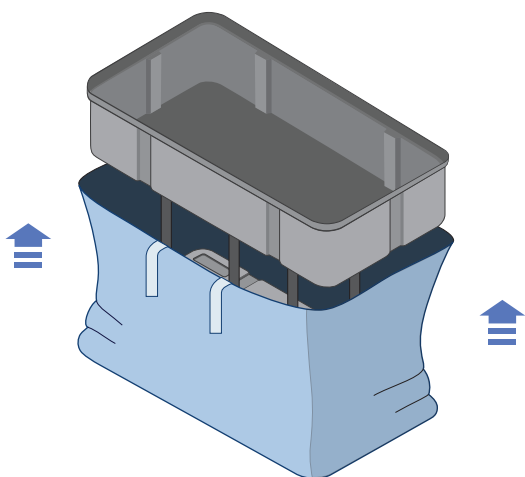

4

Attach the Counter Top

