

# QuickZip™ Bridge Display

## ASSEMBLY INSTRUCTIONS

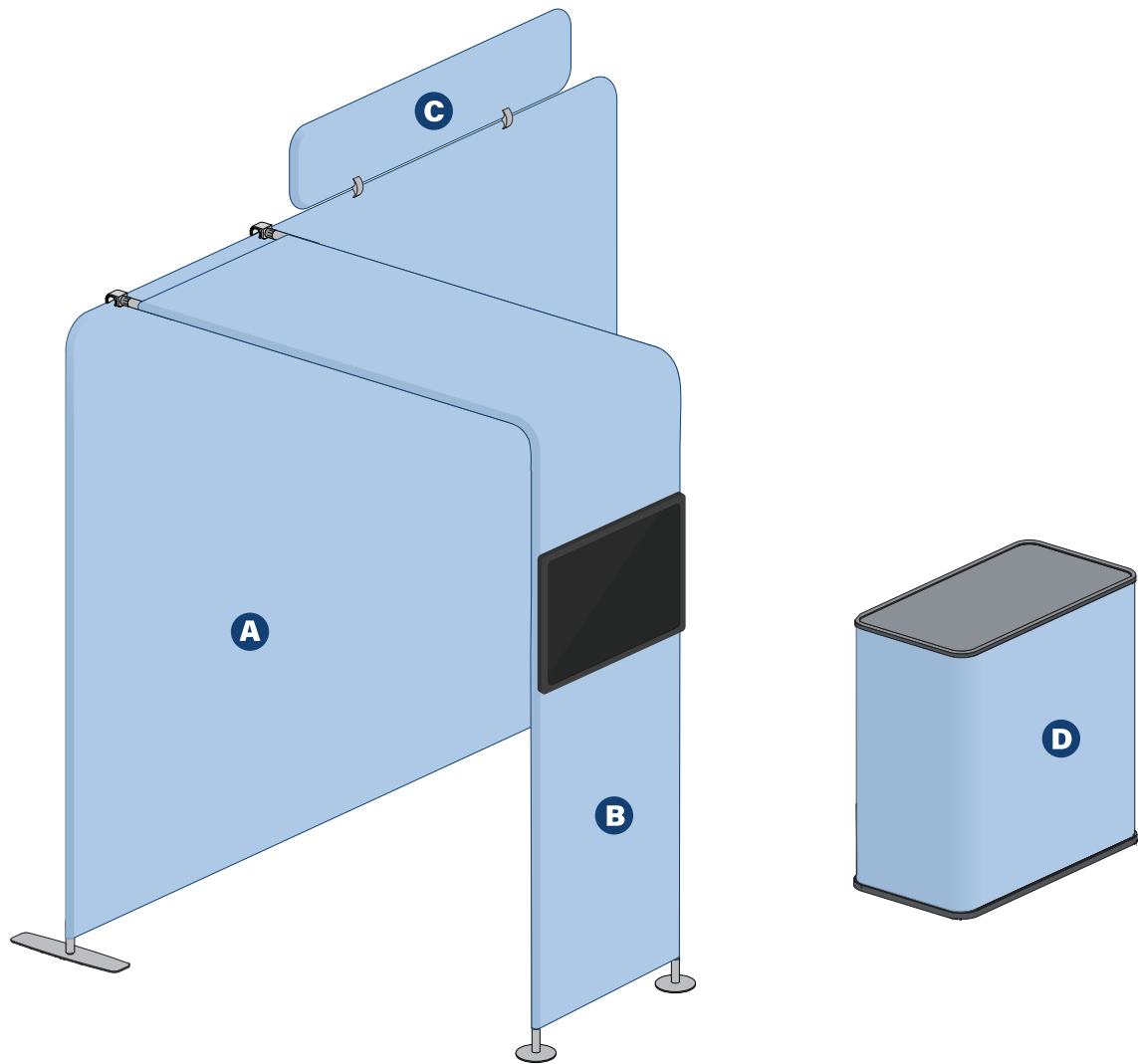

### INCLUDED:

- A** QuickZip™ Straight Display
- B** QuickZip™ Archway
- C** QuickZip™ Header
- D** Hardcase Podium

# **A** QuickZip™ Straight Display

## ASSEMBLY INSTRUCTIONS

### BOX CONTENTS



(5) Connected Poles

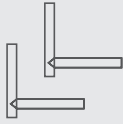

(2) Bottom Corners



(2) Top Corners

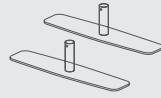

(2) Support Feet



(2) Light Clips

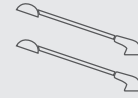

(2) LED Lights  
(Optional)



(1) Backdrop Graphic  
(Ships Separately)

1

### Assemble the Frame

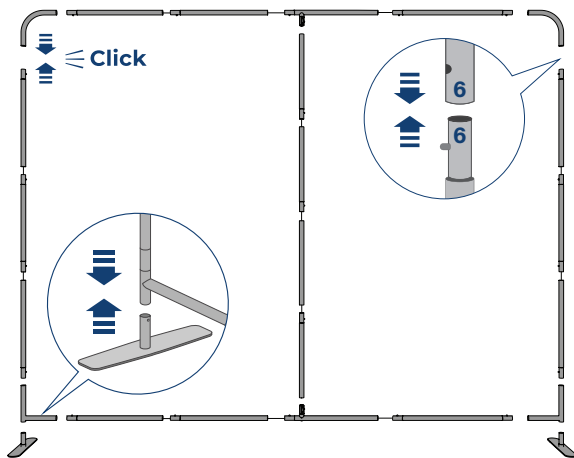

2

### Install the Graphic

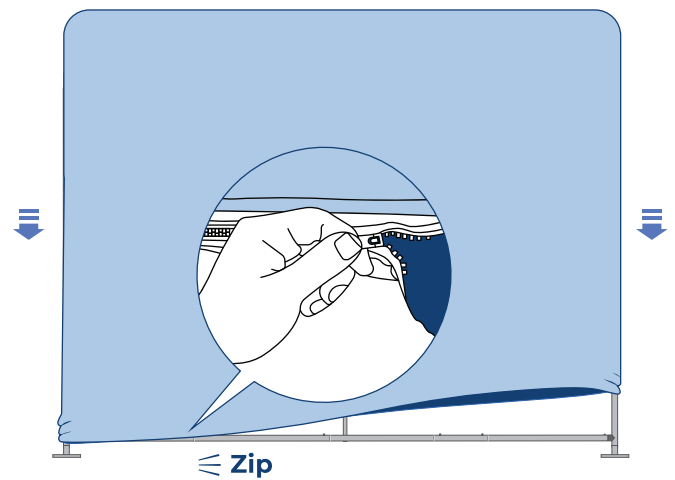

3

### Attach LED Lights (Optional)

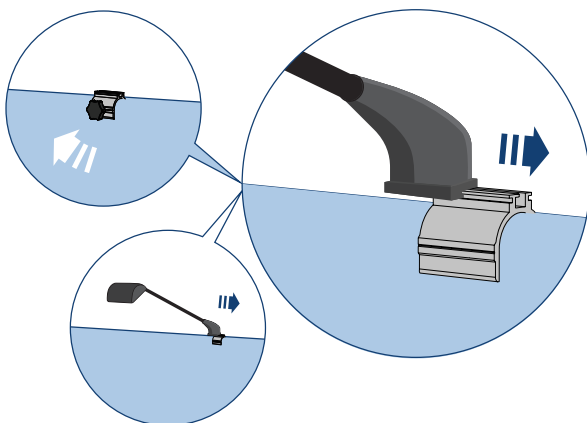

To avoid damage, do not twist the knobs too tight.

4

### Align the Display

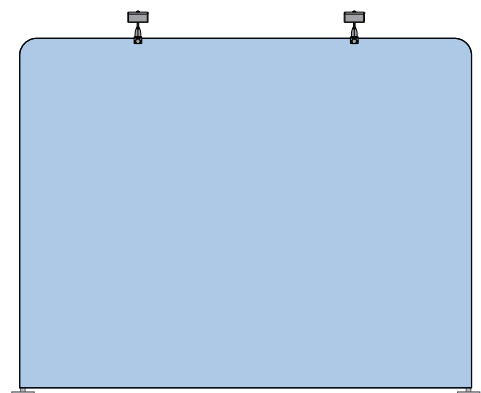

The poles can be maneuvered to stand upright if the frame is leaning



# QuickZip™ Archway

## ASSEMBLY INSTRUCTIONS

### BOX CONTENTS



(3) Center Support Poles



(2) TV Mount Support Poles



(2) Support Feet

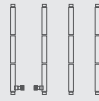

(4) Connected Poles

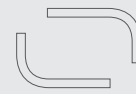

(2) Corner Poles



(1) TV Stand Graphic  
(Ships Separately)

### BOX CONTENTS - TV MOUNT

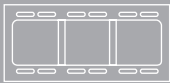

(1) TV Mount



(2) TV Mount Brackets



(4) M5/M6 Washers



(4) Spacers



(4) M4 x 10mm



(4) M5 x 30mm



(4) M6 x 30mm



(4) M8 x 30mm

#### NOT FOR USE WITH DISPLAY



(4) Wall Anchors



(4) Wall Anchor Screws



(4) Washers

1

## Assemble the Frame

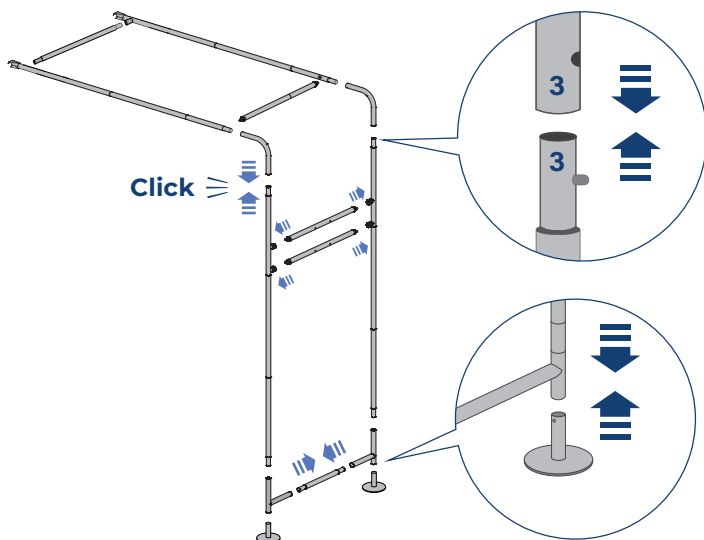

Connect the two sides together with the center support poles and TV Support poles. Ensure all hubs are tightened securely.

2

## Install the Graphic

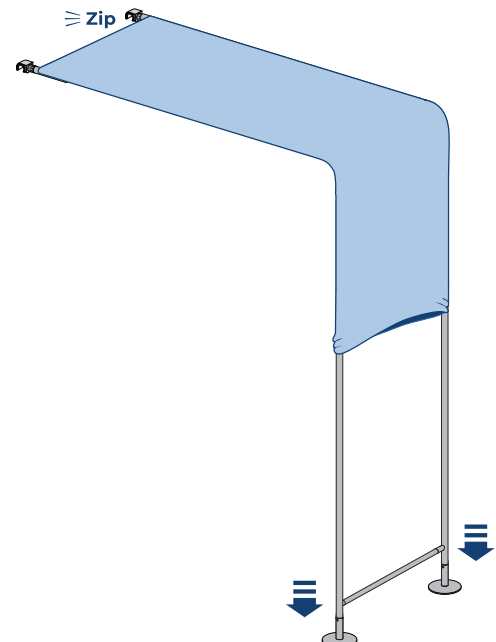

It helps to have a second person to pull the other side simultaneously.

3

### Attach to Backdrop

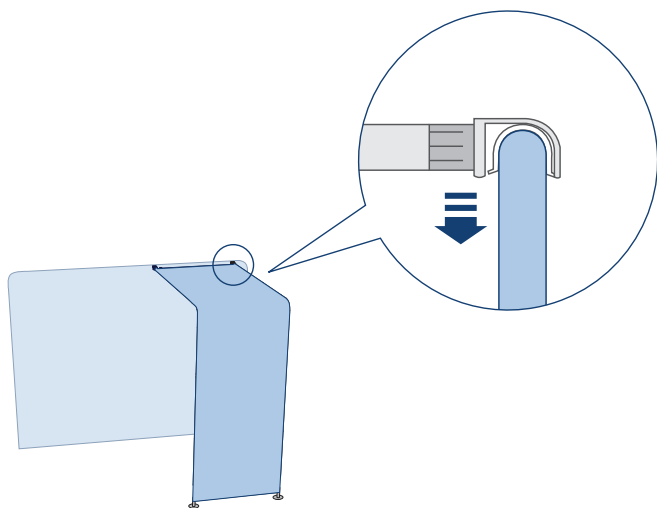

4

### Attach TV Mount

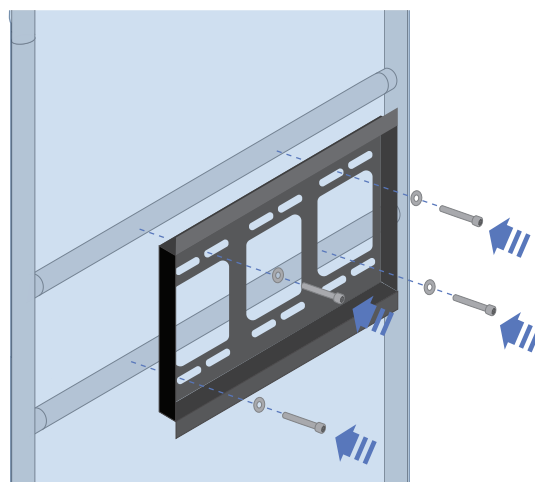

*Screw the TV Mount on the display using the M6 Screws and M6 washers.*

5

### Attach Brackets to Monitor

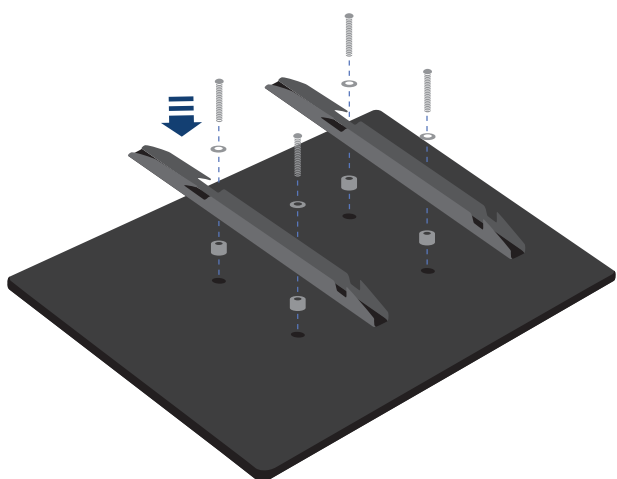

*Use the Spacers and M4, M5, or M8 Screws.*

6

### Attach Monitor to Stand

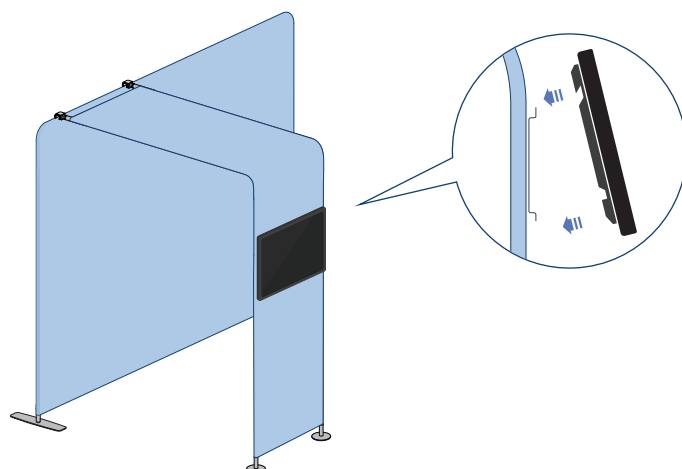

# QuickZip™ Header Display

## ASSEMBLY INSTRUCTIONS

### BOX CONTENTS



(2) Side Poles



(2) Top & Bottom Poles



(2) Header Clamps



(1) Header Graphic  
(Ships Separately)

1

### Assemble the Frame

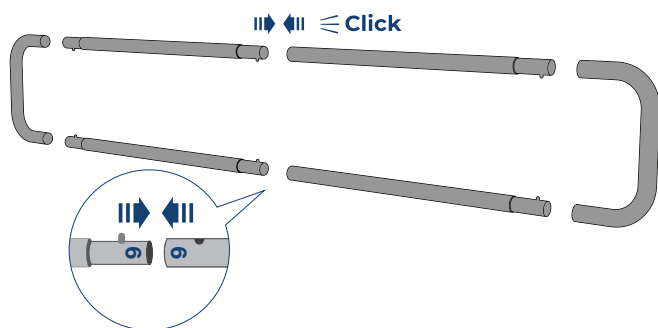

Match numbers 1 to 1, 2 to 2, etc.

2

### Install the Graphic

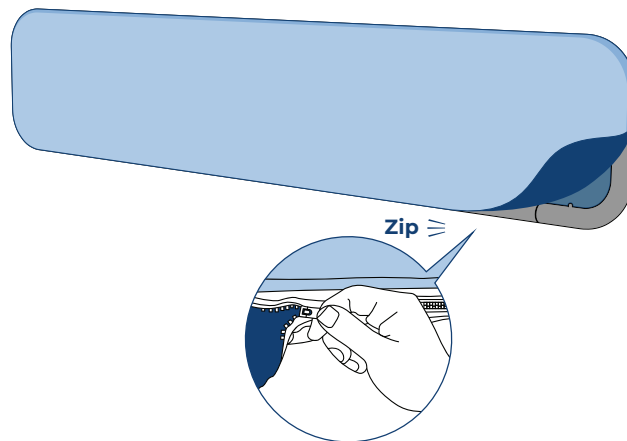

3

### Attach Header to Backdrop

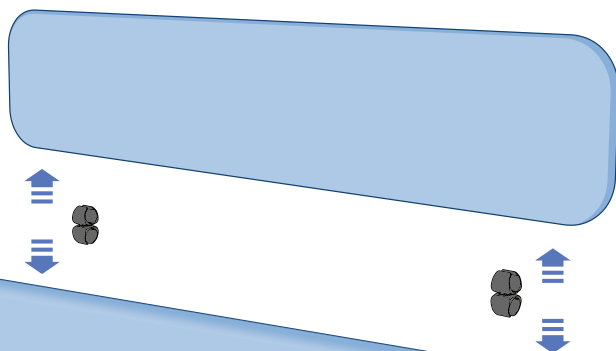

4

### Align the Display

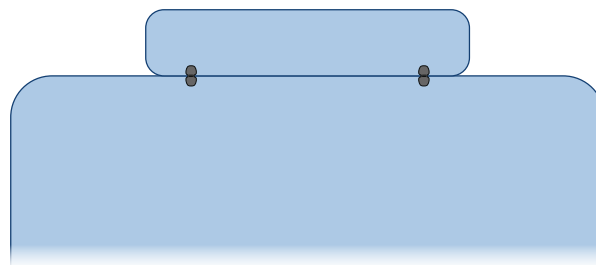



# Hardcase / Podium

## ASSEMBLY INSTRUCTIONS

### BOX CONTENTS

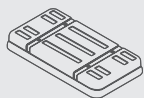

(1) Case Lid

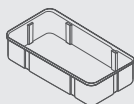

(1) Storage Case



(1) Counter Top

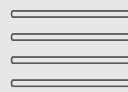

(4) Poles



(1) Podium Graphic  
(Ships Separately)

1

### Prepare the Base

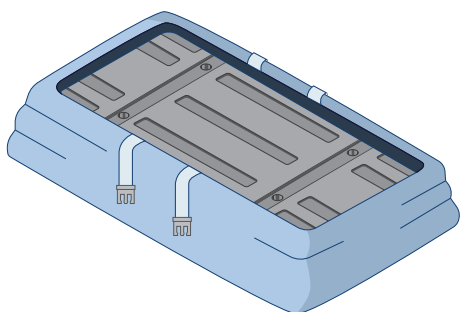

*Tuck the bottom end of the Graphic under the Case Lid*

2

### Set Up the Hardware

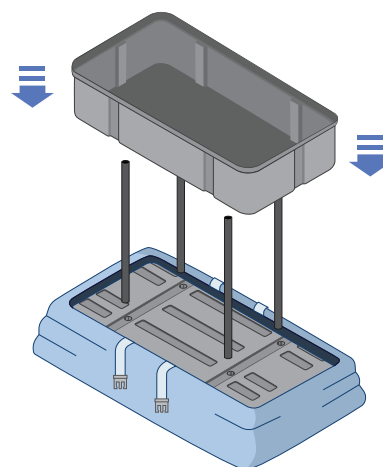

*Install the Poles into the Case Lid, then install the Storage Case.*

3

### Pull Up Graphics

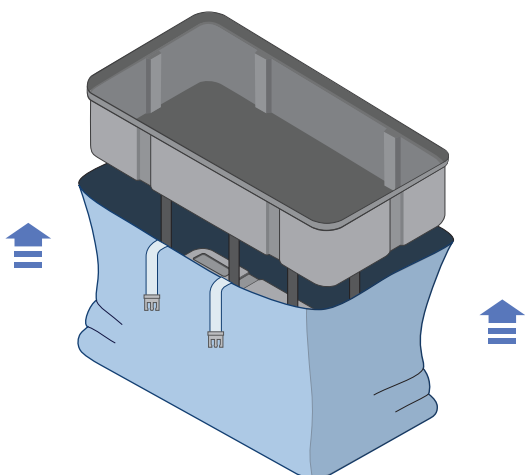

4

### Attach the Counter Top

