

# QuickZip™ Executive Display

## ASSEMBLY INSTRUCTIONS

### BOX CONTENTS - FRAME HARDWARE



(2) Connector Clamps



(12) Support Poles



(3) Bottom Corners



(6) Top Corners

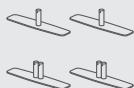

(4) Support Feet



(3) Light Clips

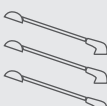

(3) LED Lights



(3) Backdrop Graphic  
(Ships Separately)

### BOX CONTENTS - TV MONITOR HARDWARE



(1) TV Mount  
Main Support



(2) TV Mount  
Brackets



(8) x Metal  
Washers



(4) 1" Screws - Thin  
For TV Bracket



(4) 1" Screws - Thick  
For TV Mount



(2) 1.5" Screws - For  
TV Bracket

### NOT FOR USE WITH DISPLAY



(4) Wall Anchors

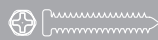

(4) Wall Anchor  
Screws

1

### Assemble the Frame

Using the numbers on the frame, connect the poles together.

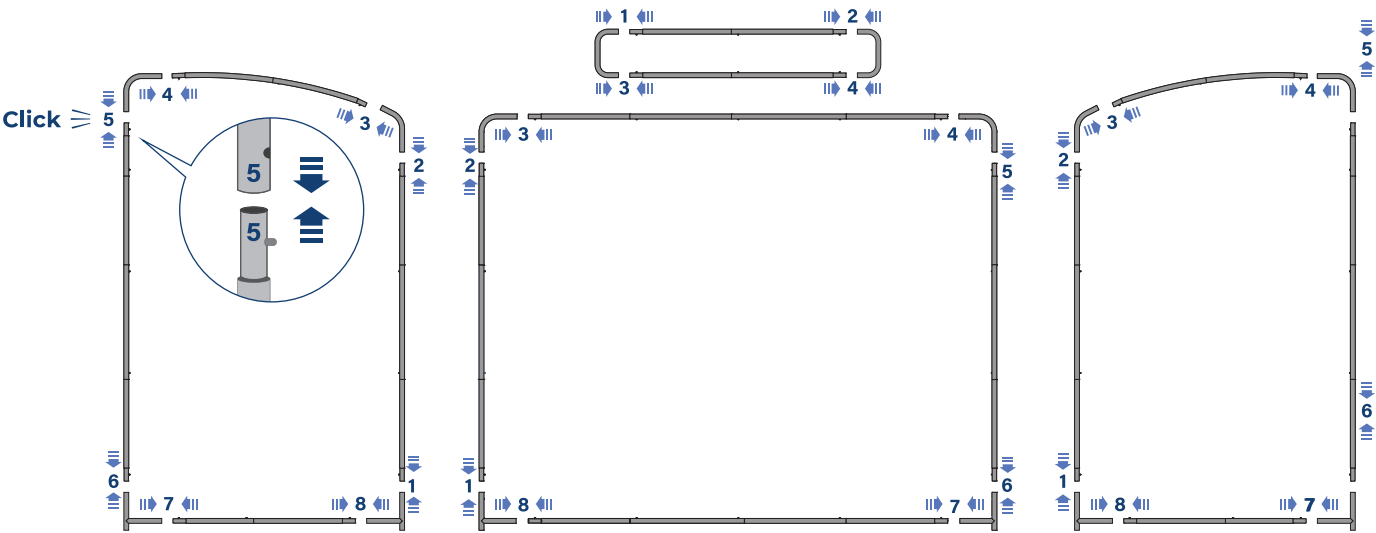

Match numbers 1 to 1, 2 to 2, etc.

2

## Install the Graphics and Attach Feet

Carefully pull the graphic print over the frame, ensuring both sides are pulled down at the same time. Attach support feet to the bottom of the frame.

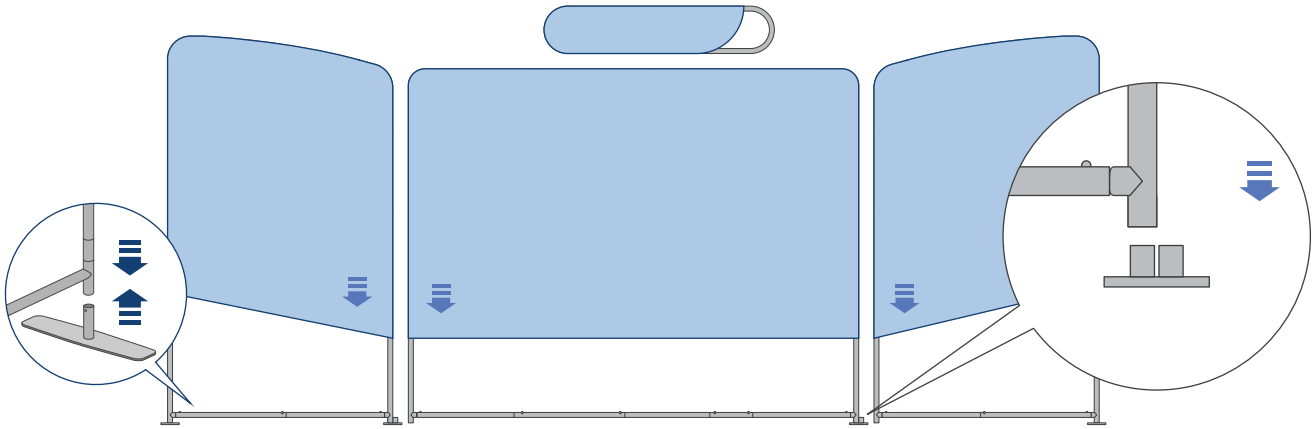

*It helps to have a second person to pull the other side simultaneously.*

3

## Attach Header and Connect Panels

Lean the frame down and attach the top header to the center panel. Then stand upright, stabilize the frame, and connect the side panels using the connector clamps and Allen key.

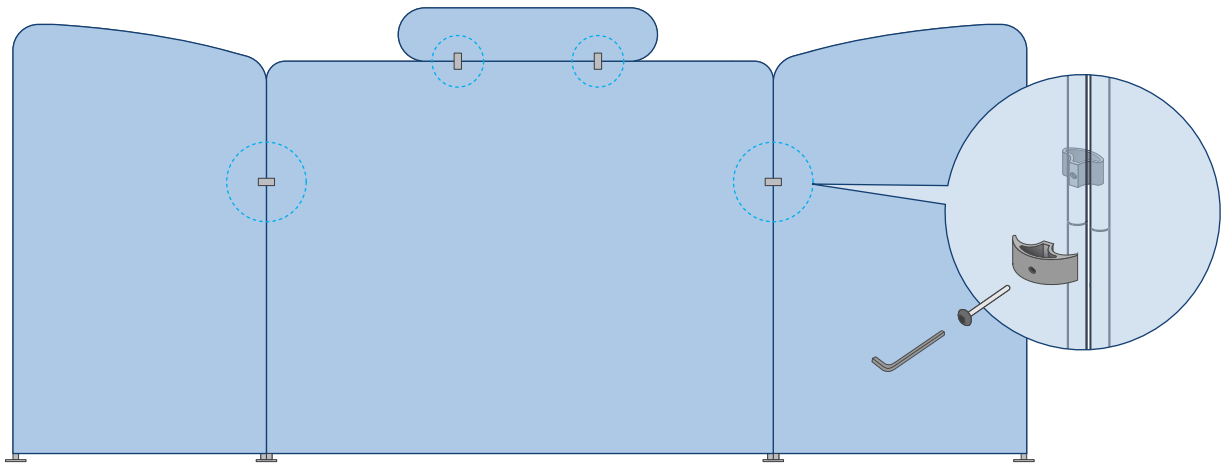

4

## Attach LED Lights

Attach light clips to the frame (knobs facing back) and tighten until secure. Slide LED lights into the top grooves.

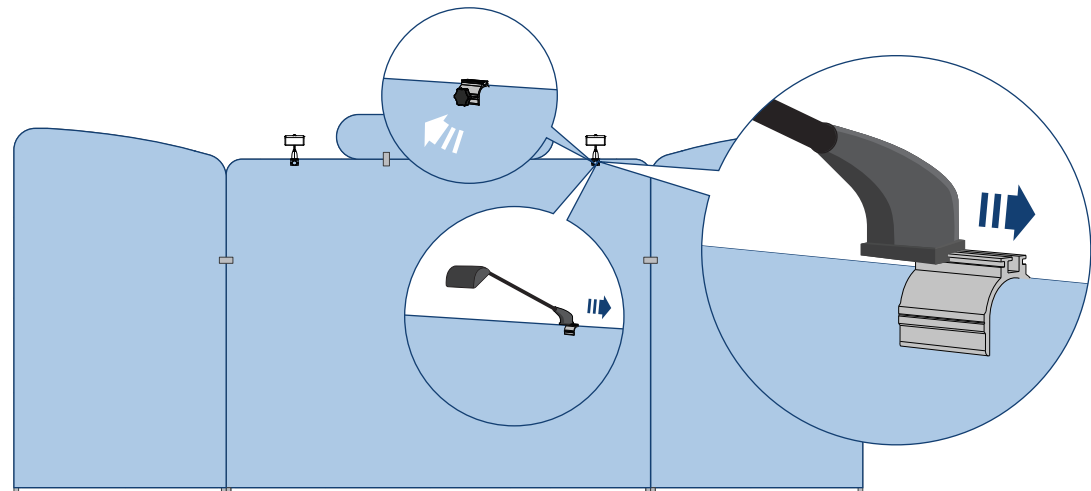

*To avoid stripping the light clips, do not twist the knobs too tight.*

5

### Attach TV Mount

Screw the TV Mount on the Waterfall using the 1" Thick Screws and metal washers.

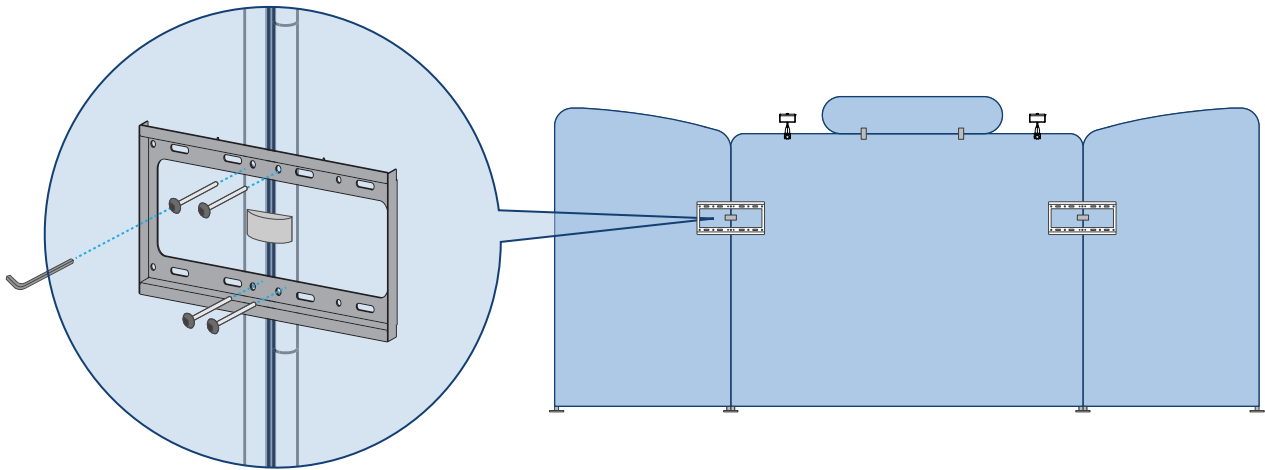

6

### Attach Brackets to Monitor

Attach the brackets on your monitor using the 1" Thin Screws.

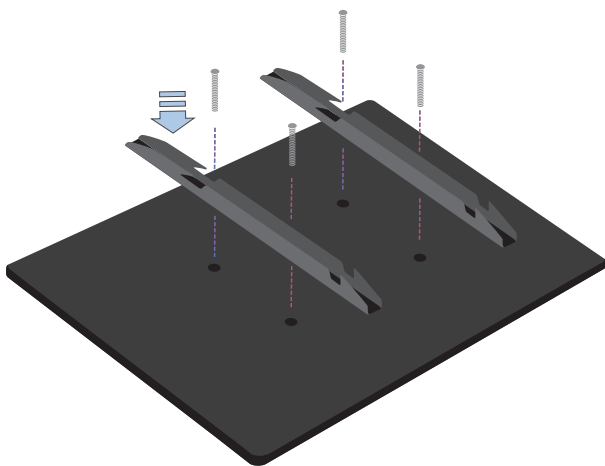

7

### Attach Monitor to Stand

Attach the monitor bracket hooks to the top of the monitor mount.

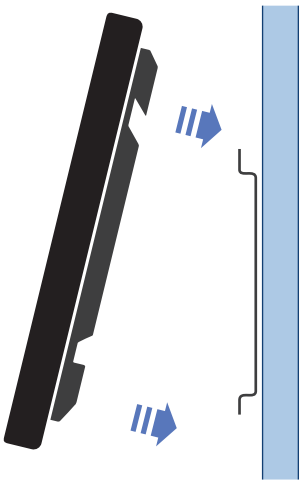

8

### Secure the Brackets

Insert the 1.5" screws into the bottom holes of the brackets in order to safely secure the monitor to the mount.

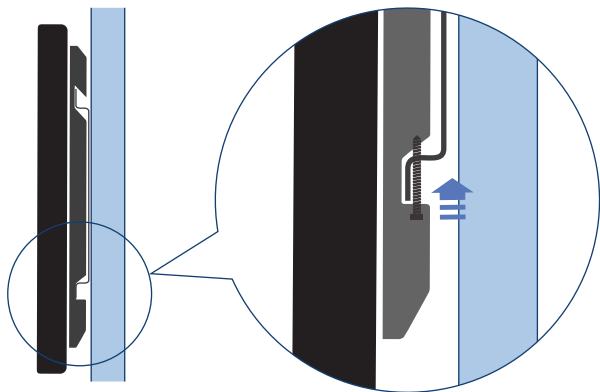

9

### Ready to go!

