

QuickZip™ Bridge Kit

ASSEMBLY INSTRUCTIONS

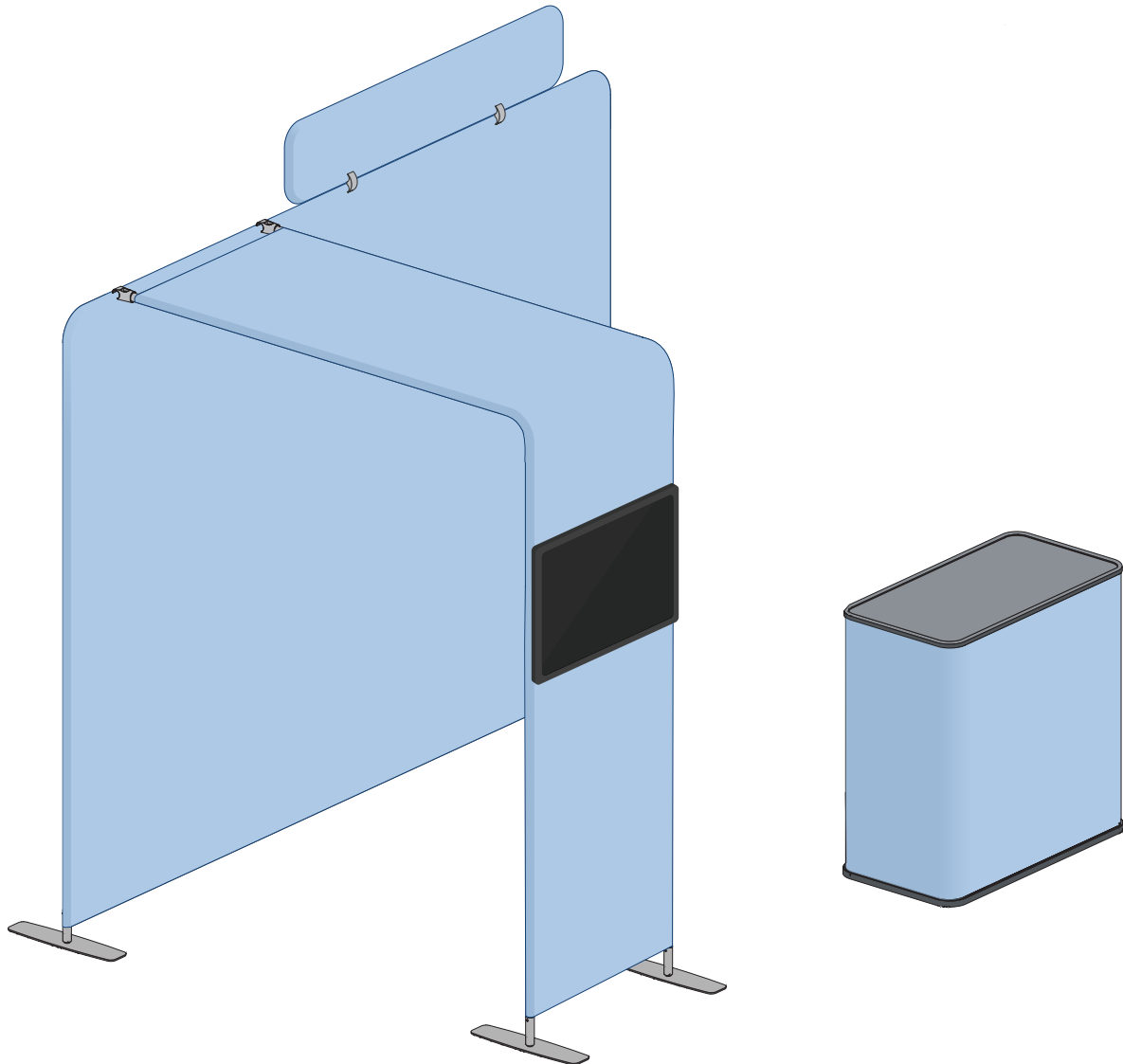

INCLUDED:

- A** QuickZip™ Straight Display
- B** QuickZip™ Header
- C** QuickZip™ Arch
- D** Hardcase Podium

QuickZip™ Straight Display

ASSEMBLY INSTRUCTIONS

BOX CONTENTS

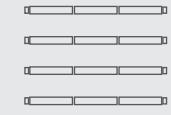

(4x) Support Poles



(2) Bottom Corners



(2) Top Corners

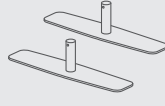

(2) Support Feet

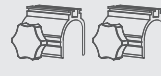

(2) Light Clips

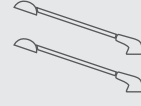

(2) LED Lights
(Optional)



(1) Backdrop Graphic
(Ships Separately)

1

Assemble the Frame

Connect the poles by matching up the numbers. Attach support feet to the bottom of the frame.

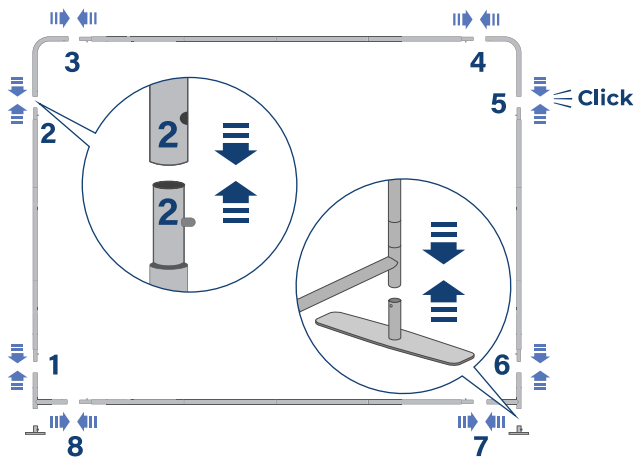

Match numbers 1 to 1, 2 to 2, etc.

2

Install the Graphic

Carefully pull the graphic print over the frame, ensuring both sides are pulled down at the same time.

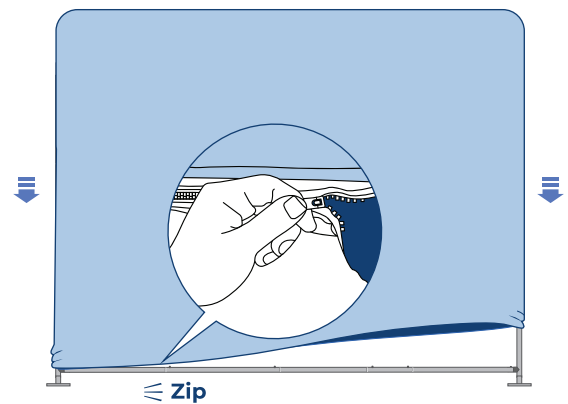

It helps to have a second person to pull the other side simultaneously.

3

Attach LED Lights (Optional)

Attach light clips to the frame (knobs facing back) and tighten until secure. Slide LED lights into the top grooves.

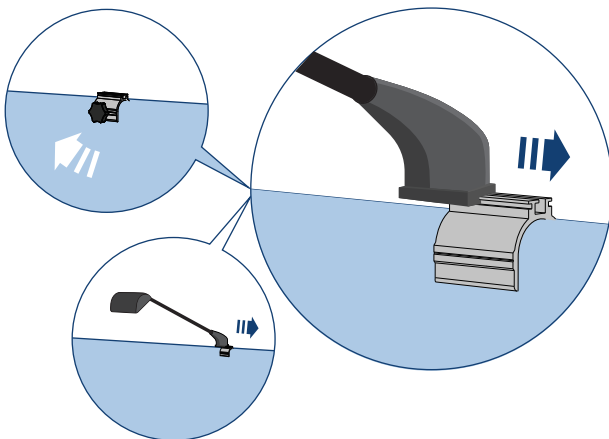

To avoid stripping the light clips, do not twist the knobs too tight.

4

Align the Display

Stand up the frame and shift or wiggle the corners until it's aligned and standing straight. Plug in your lights and your display is ready for action!

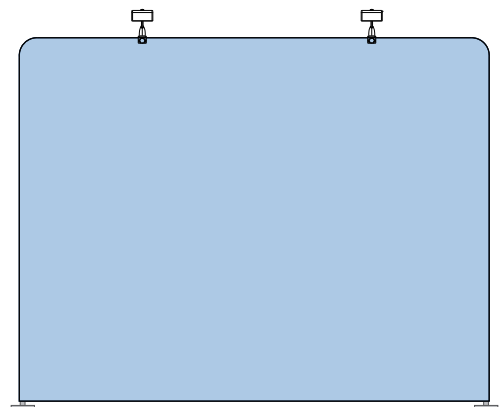

You can adjust the frame alignment by having a person on each side gently shift the top corners until the display stands completely straight.

QuickZip™ Header

ASSEMBLY INSTRUCTIONS

BOX CONTENTS



(2) Side Poles



(2) Top & Bottom Poles



(2) Short Clamps



(1) Allen Key



(1) Header Graphic
(Ships Separately)

1

Assemble the Frame

Connect the poles by matching up the numbers.

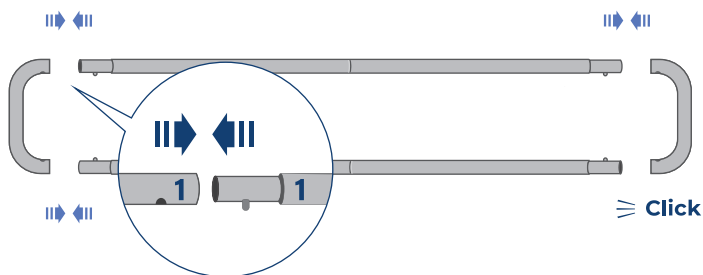

Match numbers 1 to 1, 2 to 2, etc.

2

Install the Graphic

Carefully pull the graphic print over the frame, ensuring both sides are pulled down at the same time.

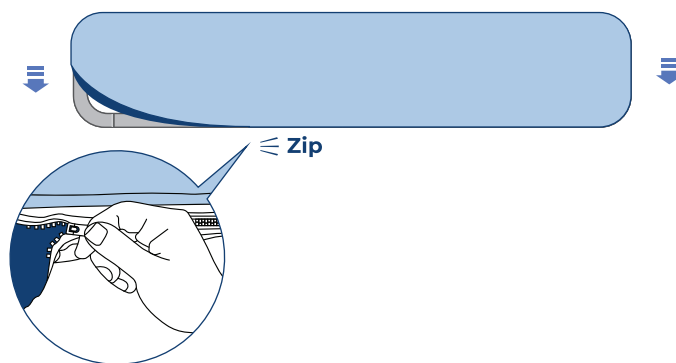

3

Attach Header to Backdrop

Starting with the display flat on the floor, align the header above the main frame and attach the clamps between the frames.

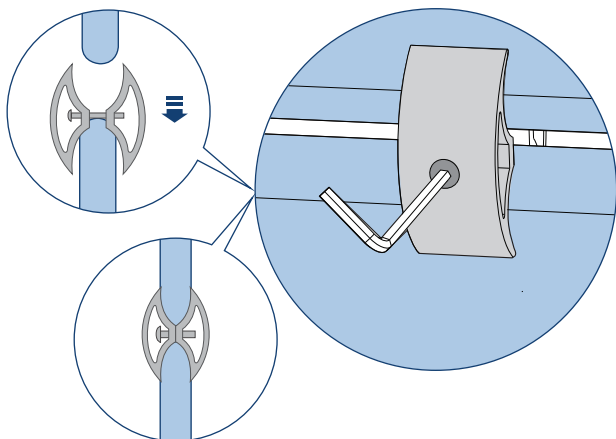

Tighten the clamps with the allen key to secure the header in place.

4

Align the Display

Carefully lift the frame and Header back to an upright position.

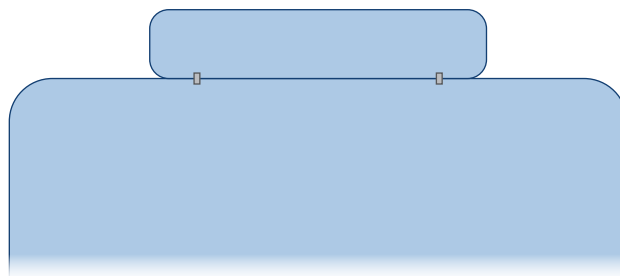

QuickZip Arch™

ASSEMBLY INSTRUCTIONS

BOX CONTENTS - ARCH HARDWARE

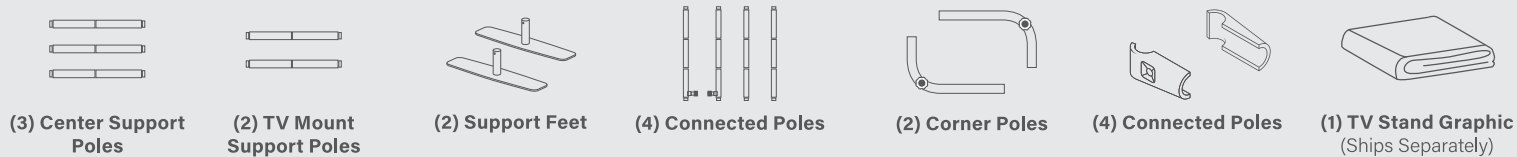

BOX CONTENTS - TV MONITOR HARDWARE

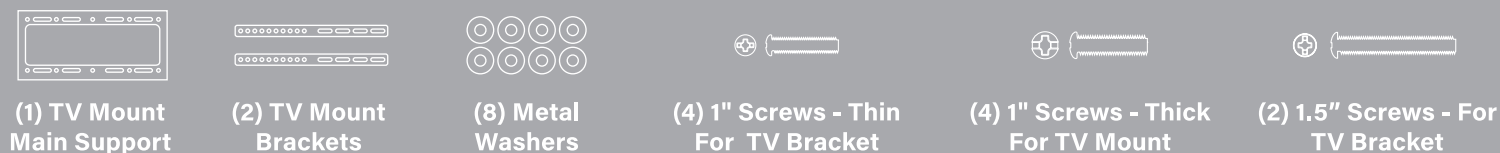

NOT FOR USE WITH DISPLAY



(4) Wall Anchors

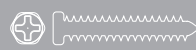

(4) Wall Anchor Screws

1

Assemble the Frame

Using the numbers, connect the poles together on the right and left sides.

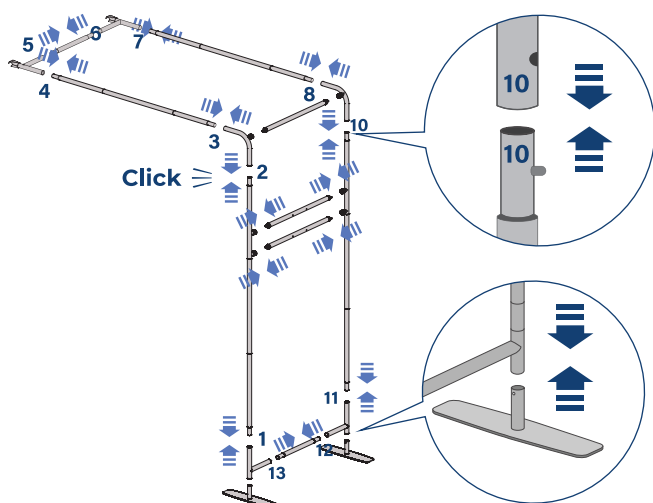

Connect the two sides together with the center support poles and TV Support poles. Ensure all hubs are tightened securely.

2

Install the Graphic

Carefully pull the graphic print over the frame, ensuring both sides are pulled down at the same time.

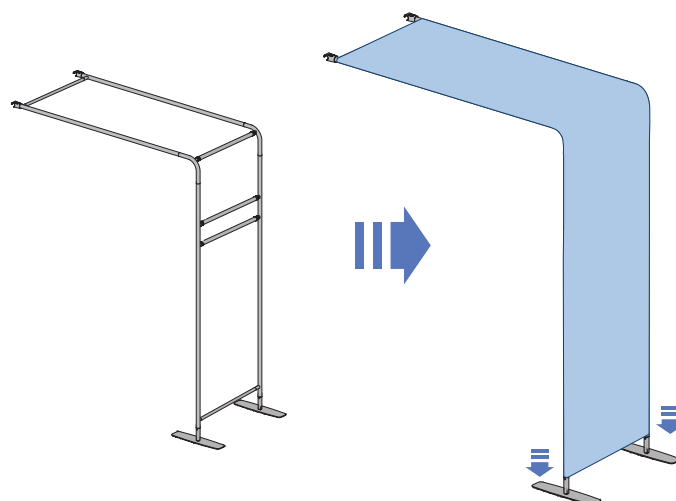

It helps to have a second person to pull the other side simultaneously.

3

Attach to Backdrop

Connect the Arch frame and backdrop with the Top Brackets. Secure tightly with the Allen key.

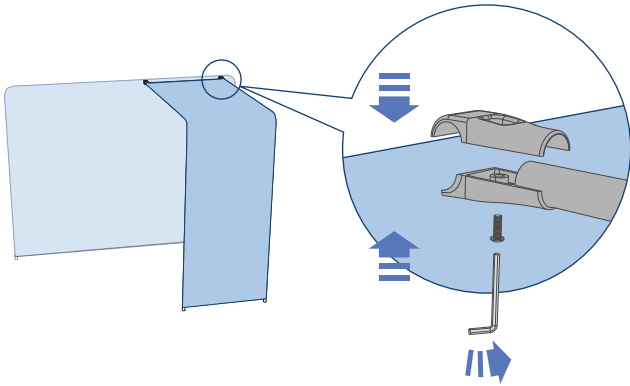

4

Attach TV Mount

Screw the TV Mount on the Waterfall using the 1" Thick Screws and metal washers.

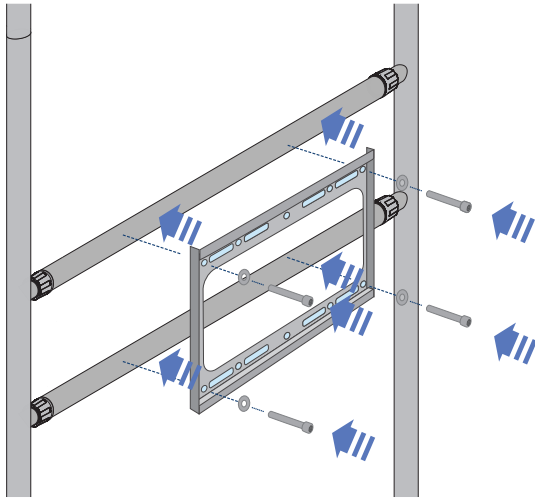

5

Attach Brackets to Monitor

Attach the brackets on your monitor using the 1" Thin Screws.

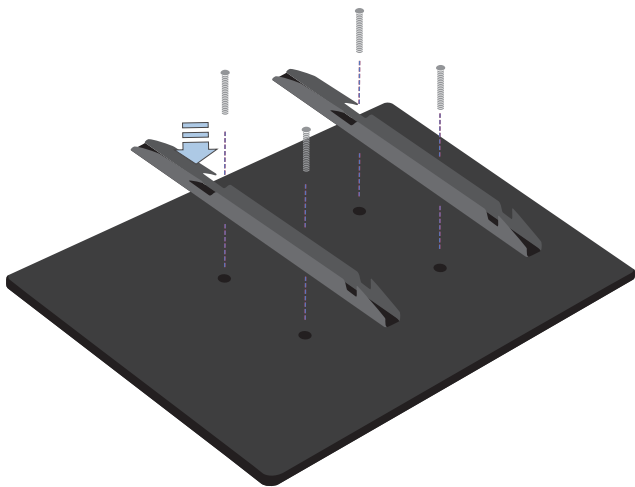

6

Attach Monitor to Stand

Attach the monitor bracket hooks to the top of the monitor mount.

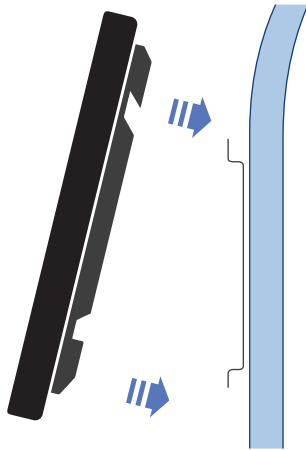

7

Secure the Brackets

Insert the 1.5" screws into the bottom holes of the brackets in order to safely secure the monitor to the mount.

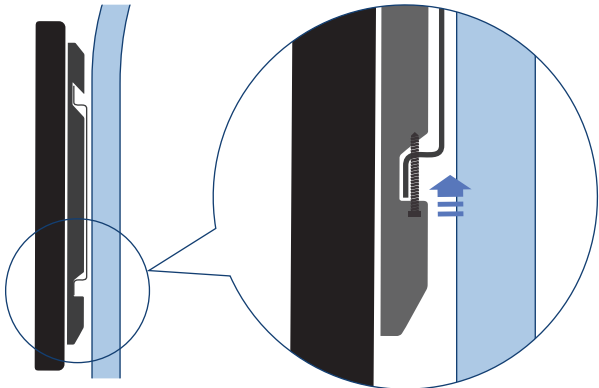

Hardcase / Podium

ASSEMBLY INSTRUCTIONS

BOX CONTENTS

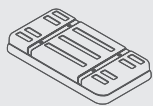

(1) Case Shell A

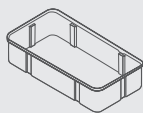

(1) Case Shell B

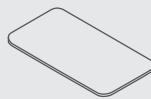

(1) Counter Top

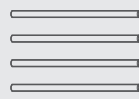

(4) Poles



(1) Podium Graphic
(Ships Separately)

1

Assemble the Frame

Place Case Shell A on the floor and securely insert the poles into the four holes. Then align Case Shell B over the four poles, match up the holes, and fit securely into place.

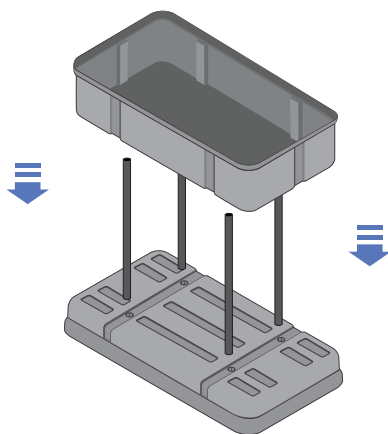

To ensure poles are inserted correctly, twist or firmly press down until they are fully secure.

2

Install the Graphic

Starting at the base, wrap the graphic around Case Shell A and pull up over the top of Case Shell B, one corner at a time. Adjust the graphic so it's straight, then zip the back.

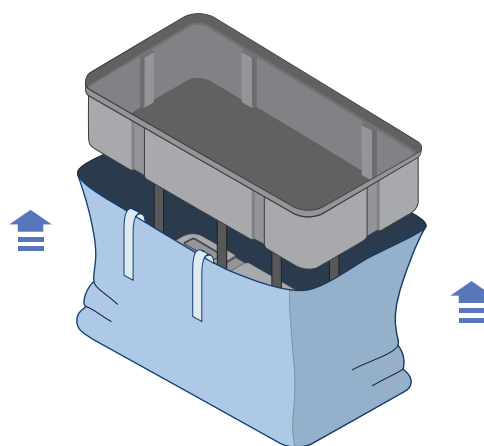

3

Attach the Counter Top

Place the black Counter Top piece on top and press down to ensure the grooves fit over the edges of the case shell.

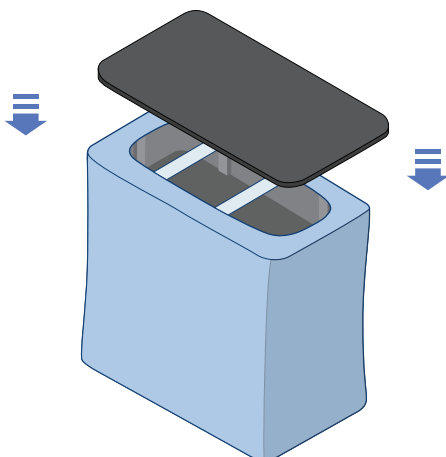

4

Store Personal Items

Hide samples, marketing materials, or personal items inside the podium by storing under the case lid or within the zipper compartment in the back. Your Podium is ready for action!

