

# QuickZip™ MAX Curved Display

## ASSEMBLY INSTRUCTIONS

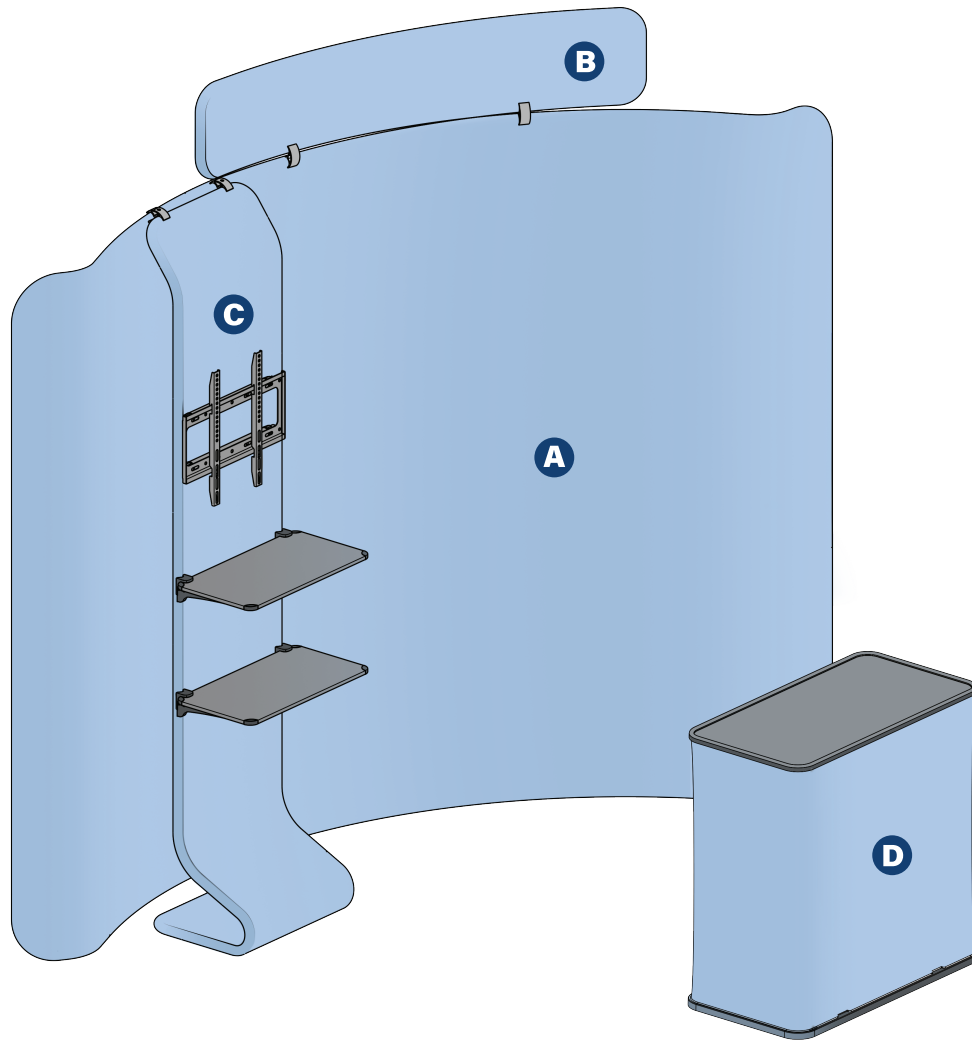

### INCLUDED:

- A** QuickZip™ Curved Display
- B** QuickZip™ Header
- C** QuickZip™ Waterfall
- D** Hardcase Podium

# QuickZip™ Curved Display

## ASSEMBLY INSTRUCTIONS

### BOX CONTENTS

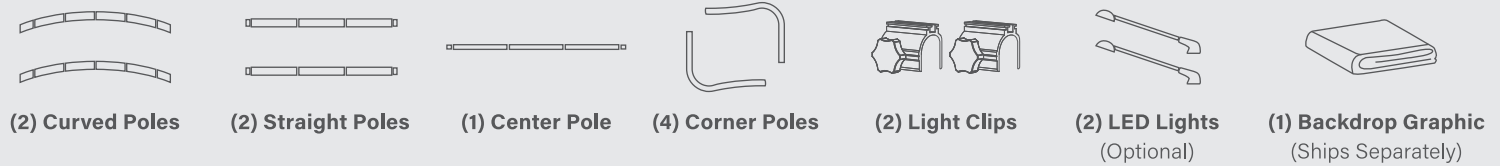

**1**

### Assemble the Frame

Connect the poles by matching up the numbers. Insert center support pole into the middle of curved poles.

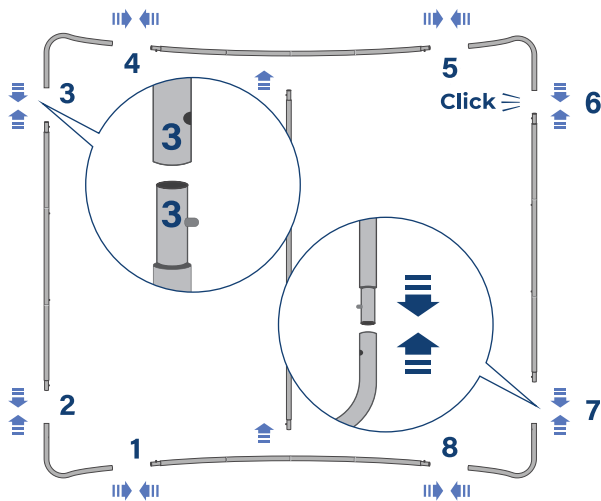

Match numbers 1 to 1, 2 to 2, etc.

**2**

### Install the Graphic

Carefully pull the graphic print over the frame, ensuring both sides are pulled down at the same time.

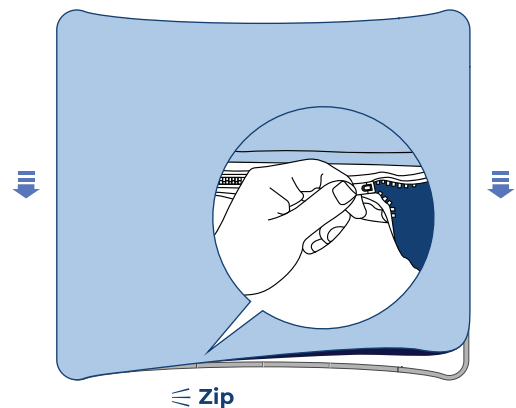

It helps to have a second person to pull the other side simultaneously.

**3**

### Attach LED Lights (Optional)

Attach light clips to the frame (knobs facing back) and tighten until secure. Slide LED lights into the top grooves.

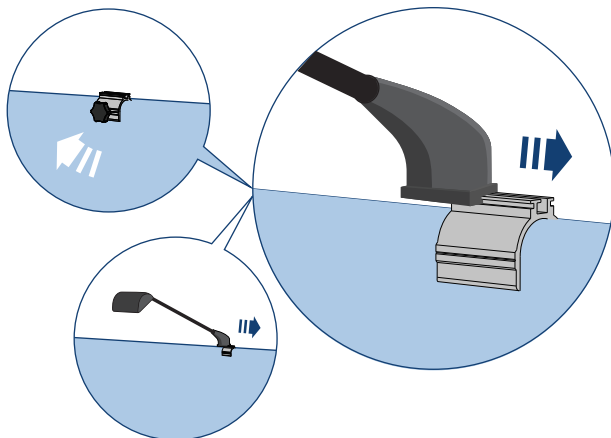

To avoid stripping the light clips, do not twist the knobs too tight.

**4**

### Align the Display

Stand up the frame and shift or wiggle the corners until it's aligned and standing upright. Plug in your lights and your display is ready for action!

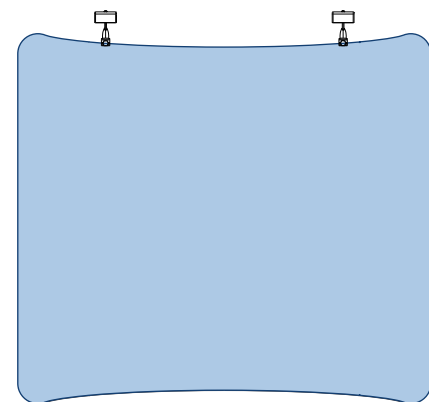

You can adjust the frame alignment by having a person on each side gently shift the top corners until the display stands completely straight.

# QuickZip™ Header

## ASSEMBLY INSTRUCTIONS

### BOX CONTENTS



(2) Side Poles



(2) Top & Bottom Poles



(2) Short Clamps



(1) Allen Key



(1) Header Graphic  
(Ships Separately)

1

### Assemble the Frame

Connect the poles by matching up the numbers.

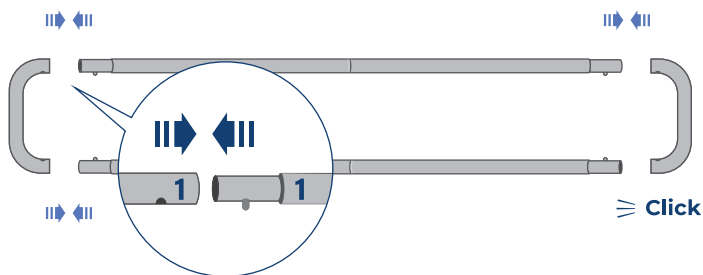

Match numbers 1 to 1, 2 to 2, etc.

2

### Install the Graphic

Carefully pull the graphic print over the frame, ensuring both sides are pulled down at the same time.

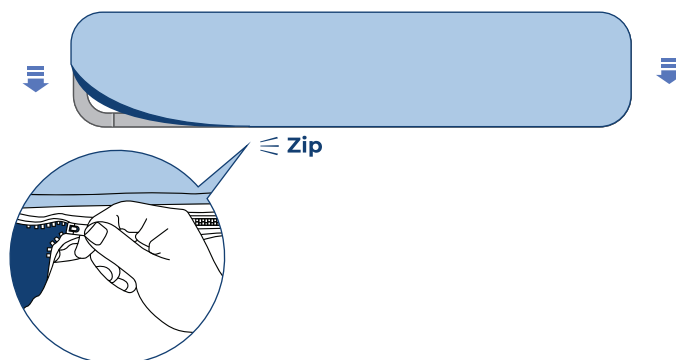

3

### Attach Header to Backdrop

Starting with the display flat on the floor, align the header above the main frame and attach the clamps between the frames.

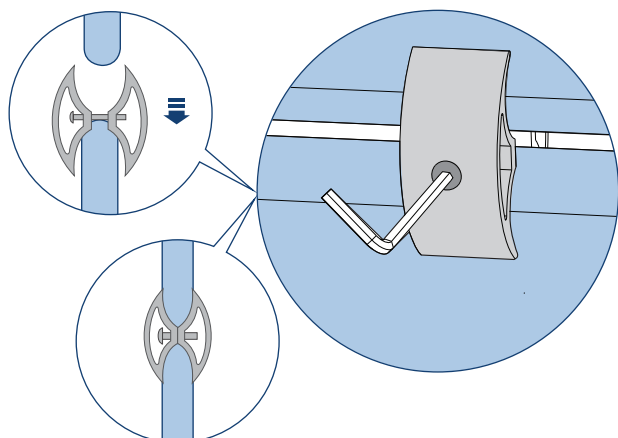

Tighten the clamps with the allen key to secure the header in place.

4

### Align the Display

Carefully lift the frame and Header back to an upright position. Your display is ready for action!

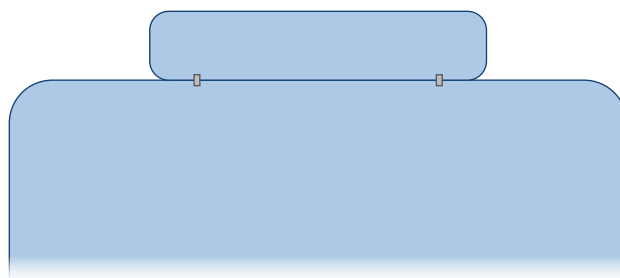

# QuickZip Waterfall™

## ASSEMBLY INSTRUCTIONS

### BOX CONTENTS - WATERFALL HARDWARE



(1) Top Connector



(2) Connected Poles



(3) Crossbars



(2) End Poles



(2) Corner Poles



(4) Shelf Screws



(2) Shelves



(4) Shelf Brackets



(1) TV Stand Graphic  
(Ships Separately)

### BOX CONTENTS - TV MONITOR HARDWARE



(1) TV Mount  
Main Support



(2) TV Mount  
Brackets



(8) Metal  
Washers



(4) 1" Screws - Thin  
For TV Bracket



(4) 1" Screws - Thick  
For TV Mount



(2) 1.5" Screws - For  
TV Bracket

### NOT FOR USE WITH DISPLAY



(4) Wall Anchors



(4) Wall Anchor  
Screws

1

### Assemble the Frame

Using the numbers on the frame, connect the poles together.

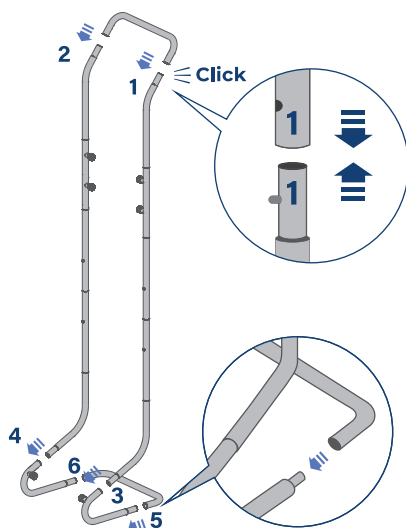

Match numbers 1 to 1, 2 to 2, etc.

2

### Connect the Poles

Connect both sides together by using the crossbars. Connect both the top and bottom end poles.

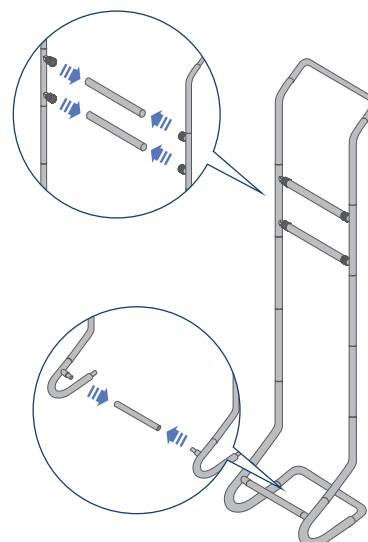

Once all crossbars are installed, tighten crossbar hubs until secure.



3

### Install the Graphic

Carefully pull the graphic print over the frame, ensuring both sides are pulled down at the same time.

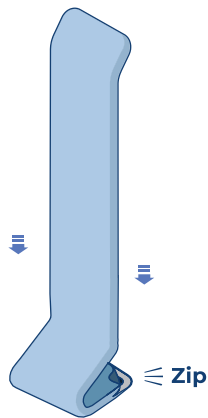

4

### Attach to Backdrop

Use the Top connector piece to attach and secure the Waterfall to the Backdrop frame.

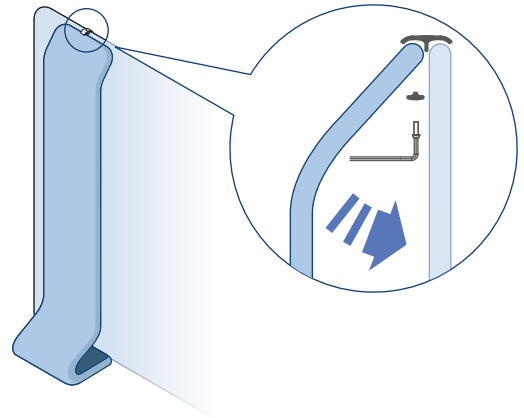

Use the Allen key to screw it in place.

5

### Attach TV Mount

Screw the TV Mount on the Waterfall using the 1" TV Mount Screws and metal washers.

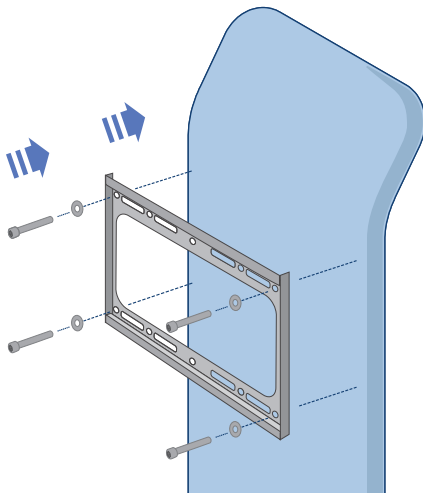

6

### Attach Brackets to Monitor

Attach the brackets on your monitor using the 1" Thin Screws.

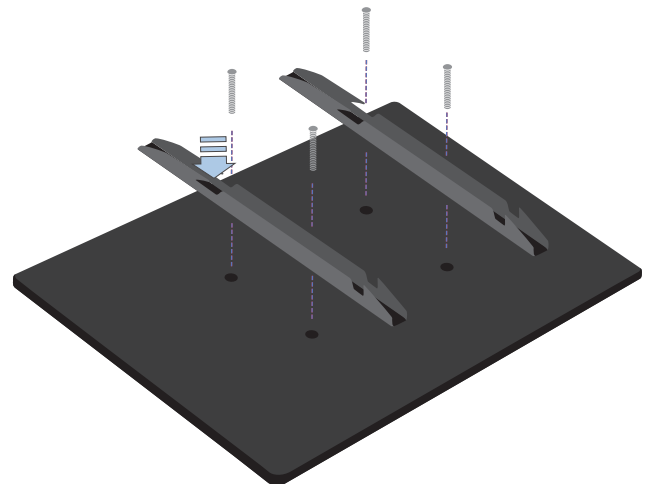

7

### Attach Monitor to Stand

Attach the monitor bracket hooks to the top of the monitor mount.

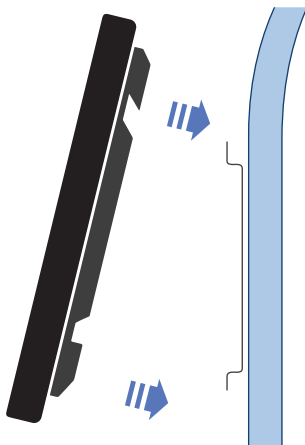

8

### Secure the Brackets

Insert the 1.5" screws into the bottom holes of the brackets in order to safely secure the monitor to the mount.

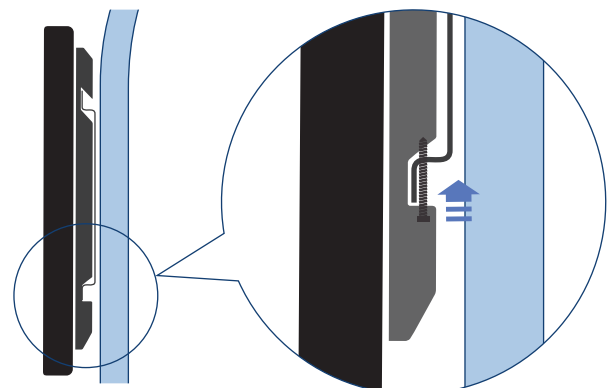

**9**

## Attach Shelf Brackets

Align the brackets through the holes in the graphic with the holes in the frame. Insert the shelf screws and into place with the Allen key.

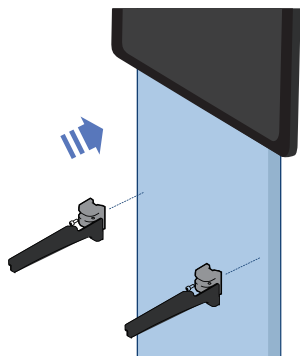

*The straight sides of the brackets should be facing up*

**10**

## Place Shelves

Place the shelf on top of the metal support and secure by sliding into the plastic brackets.

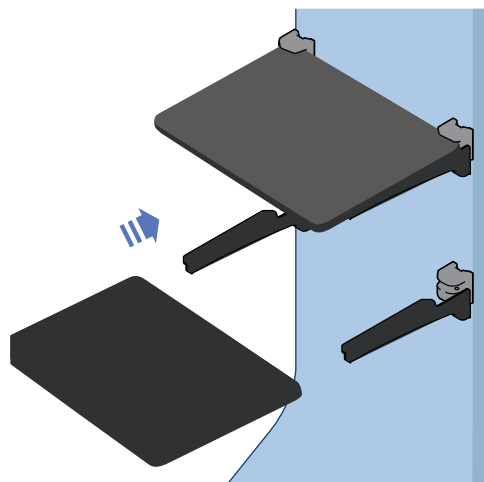

# Hardcase / Podium

## ASSEMBLY INSTRUCTIONS

### BOX CONTENTS

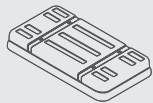

(1) Case Shell A

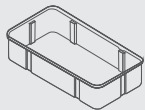

(1) Case Shell B

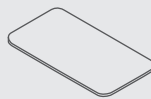

(1) Counter Top

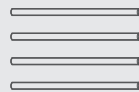

(4) Poles



(1) Podium Graphic  
(Ships Separately)

1

### Assemble the Frame

Place Case Shell A on the floor and securely insert the poles into the four holes. Then align Case Shell B over the four poles, match up the holes, and fit securely into place.

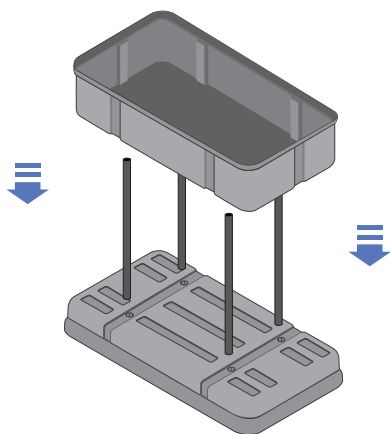

*To ensure poles are inserted correctly, twist or firmly press down until they are fully secure.*

2

### Install the Graphic

Starting at the base, wrap the graphic around Case Shell A and pull up over the top of Case Shell B, one corner at a time. Adjust the graphic so it's straight, then zip the back.

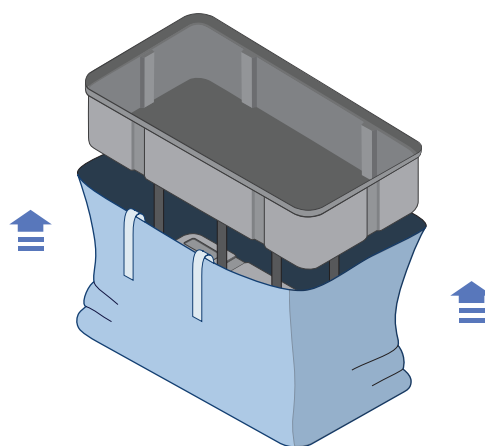

3

### Attach the Counter Top

Place the black Counter Top piece on top and press down to ensure the grooves fit over the edges of the case shell.

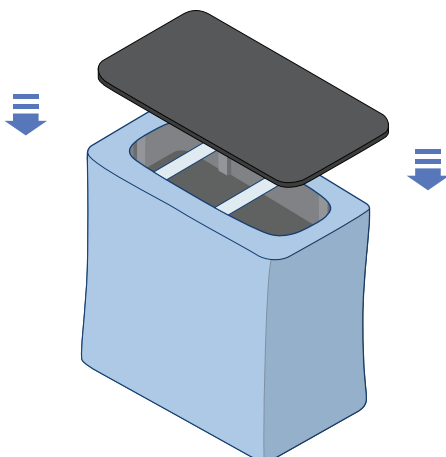

4

### Store Personal Items

Hide samples, marketing materials, or personal items inside the podium by storing under the case lid or within the zipper compartment in the back. Your Podium is ready for action!

