

QuickZip™ Showcase Kit B

ASSEMBLY INSTRUCTIONS

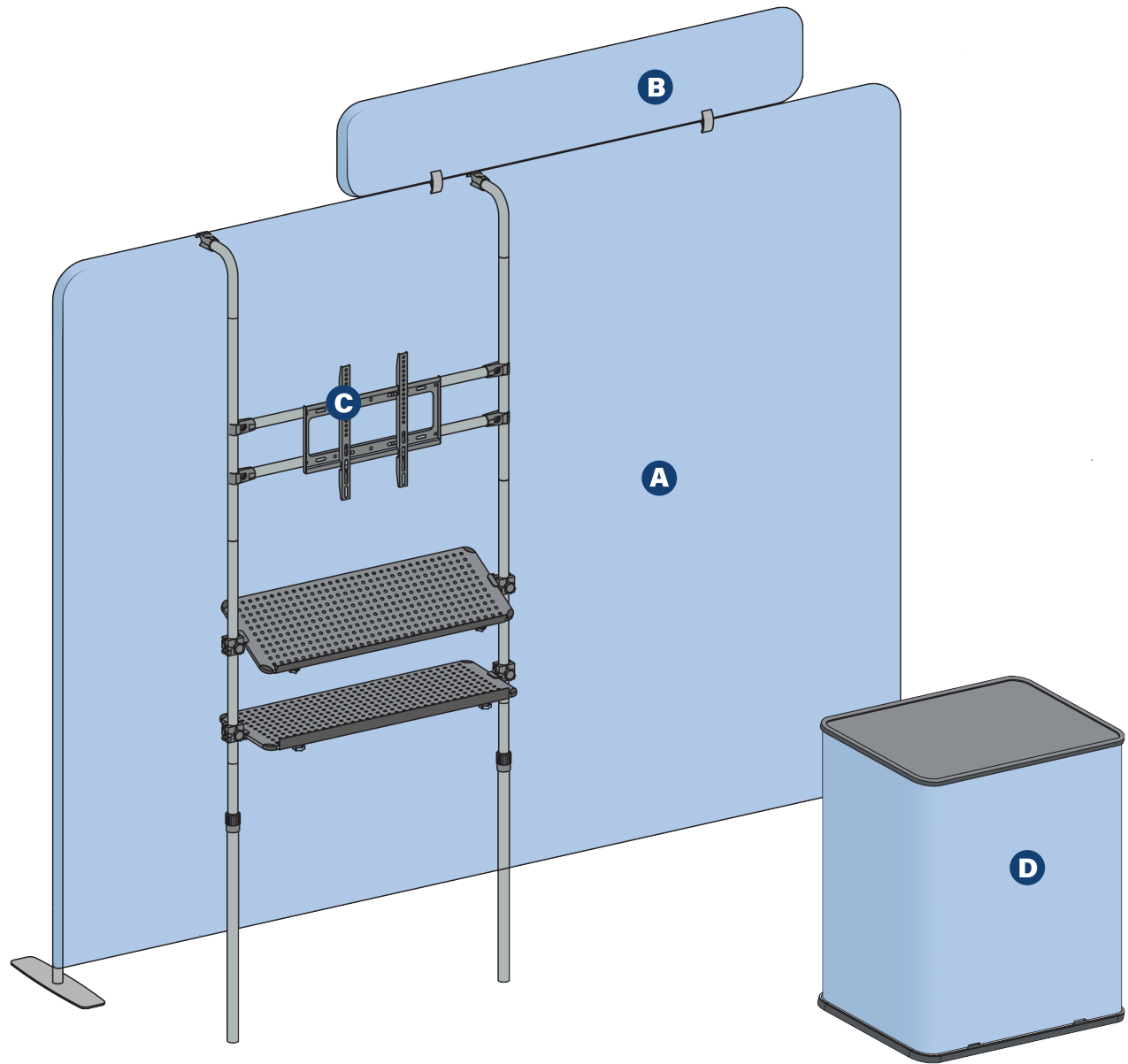

INCLUDED:

- A** QuickZip™ Straight Display
- B** QuickZip™ Header
- C** QuickZip™ Showcase Kit B
- D** Hardcase Podium

QuickZip™ Straight Display

ASSEMBLY INSTRUCTIONS

BOX CONTENTS



(4x) Support Poles



(2) Bottom Corners



(2) Top Corners

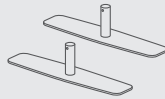

(2) Support Feet



(2) Light Clips

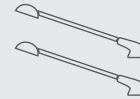

(2) LED Lights
(Optional)



(1) Backdrop Graphic
(Ships Separately)

1

Assemble the Frame

Connect the poles by matching up the numbers. Attach support feet to the bottom of the frame.

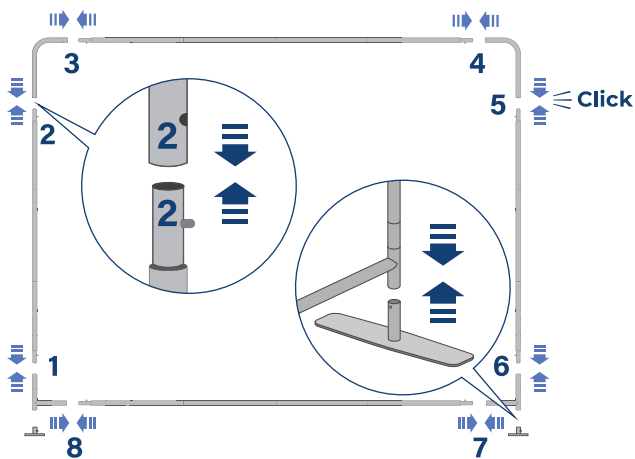

Match numbers 1 to 1, 2 to 2, etc.

2

Install the Graphic

Carefully pull the graphic print over the frame, ensuring both sides are pulled down at the same time.

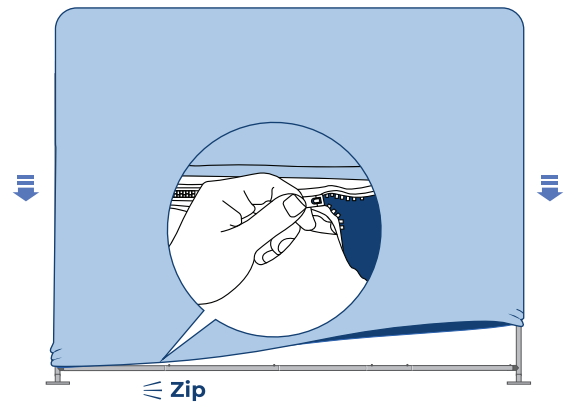

It helps to have a second person to pull the other side simultaneously.

3

Attach LED Lights (Optional)

Attach light clips to the frame (knobs facing back) and tighten until secure. Slide LED lights into the top grooves.

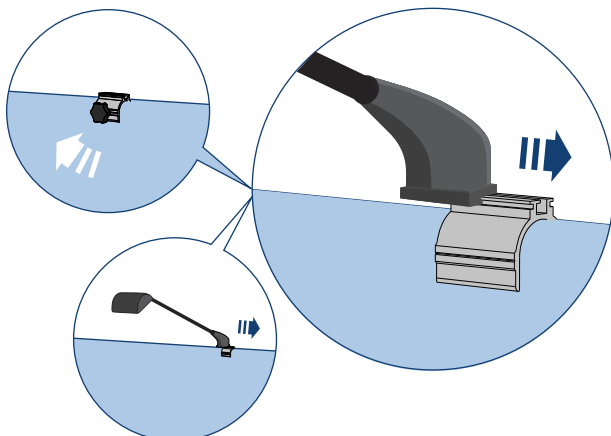

To avoid stripping the light clips, do not twist the knobs too tight.

4

Align the Display

Stand up the frame and shift or wiggle the corners until it's aligned and standing straight. Plug in your lights and your display is ready for action!

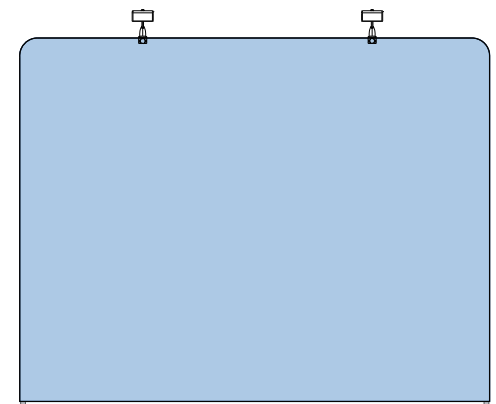

You can adjust the frame alignment by having a person on each side gently shift the top corners until the display stands completely straight.

QuickZip™ Header

ASSEMBLY INSTRUCTIONS

BOX CONTENTS



(2) Side Poles



(2) Top & Bottom Poles



(2) Short Clamps



(1) Allen Key



(1) Header Graphic
(Ships Separately)

1

Assemble the Frame

Connect the poles by matching up the numbers.

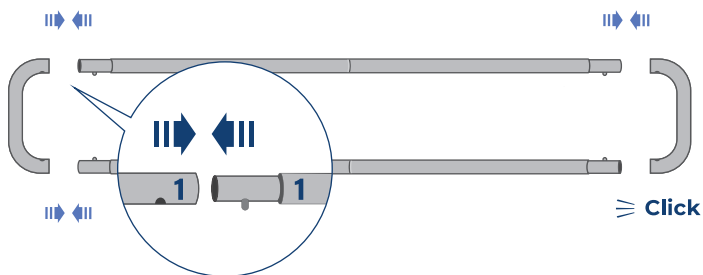

Match numbers 1 to 1, 2 to 2, etc.

2

Install the Graphic

Carefully pull the graphic print over the frame, ensuring both sides are pulled down at the same time.

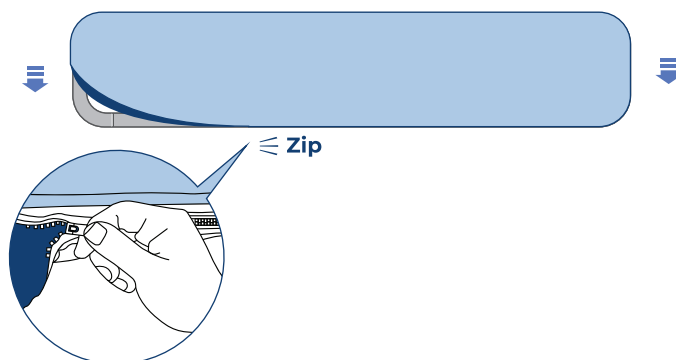

3

Attach Header to Backdrop

Starting with the display flat on the floor, align the header above the main frame and attach the clamps between the frames.

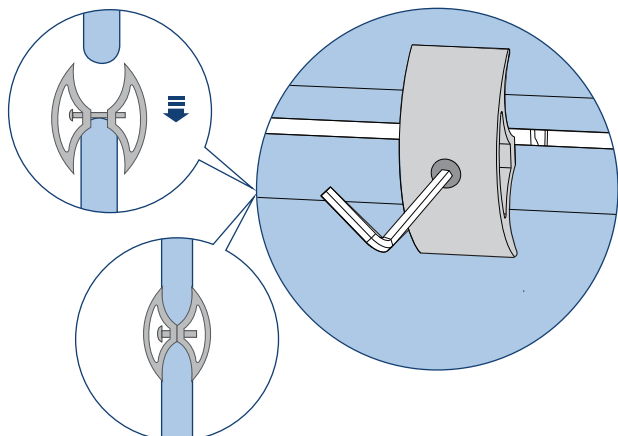

Tighten the clamps with the allen key to secure the header in place.

4

Align the Display

Carefully lift the frame and Header back to an upright position.

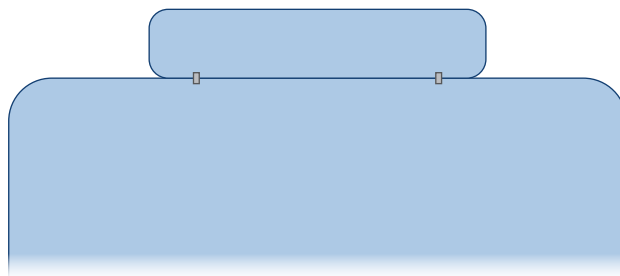

QuickZip™ Showcase - Kit B

ASSEMBLY INSTRUCTIONS

BOX CONTENTS

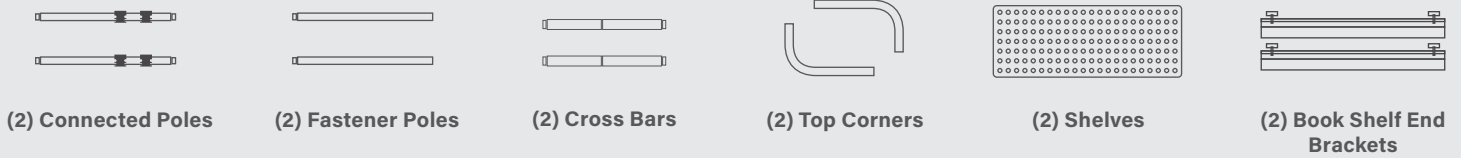

BOX CONTENTS - TV MONITOR HARDWARE

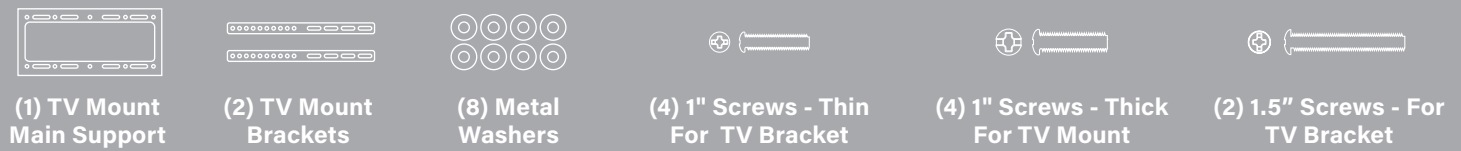

NOT FOR USE WITH DISPLAY



1 Assemble the Frame

Connect the poles with the shelf support hubs to the fastener poles and the top corners.

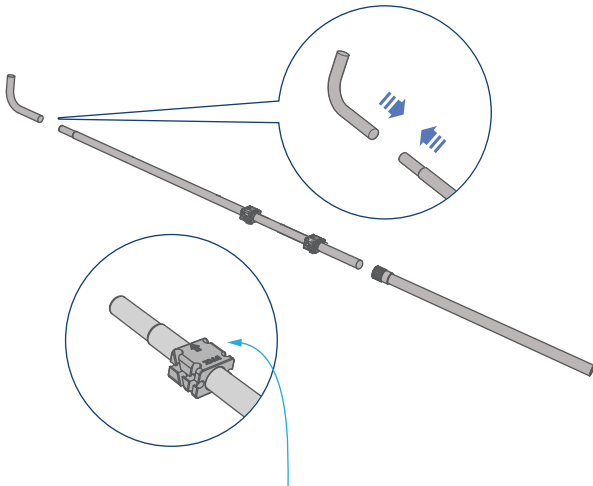

The arrow mark on the hubs should point up.

2 Attach to Backdrop

Insert the top of the aluminum tube in between the metal clamp & attach the metal clamp to the backdrop and fasten the screw.

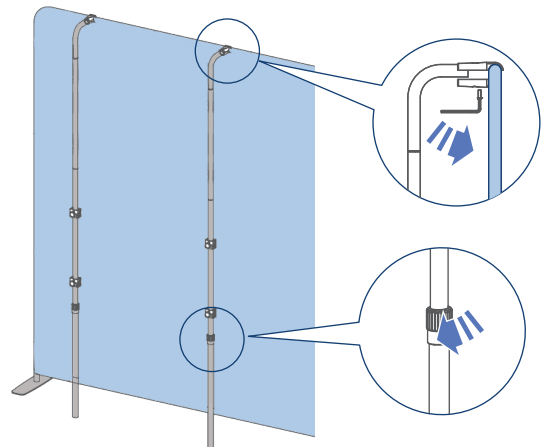

Adjust the tube's height and tighten in place with the twist knob.

3

Attach Flat Shelf

Slide the shelf into the shelf support hubs from the front.

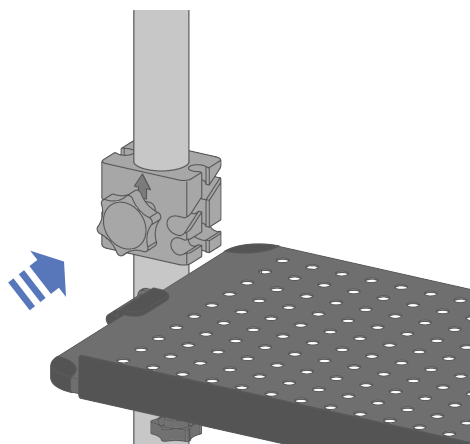

4

Sloping Shelves

Slide the shelf into the shelf support hubs from the back at a 45° angle

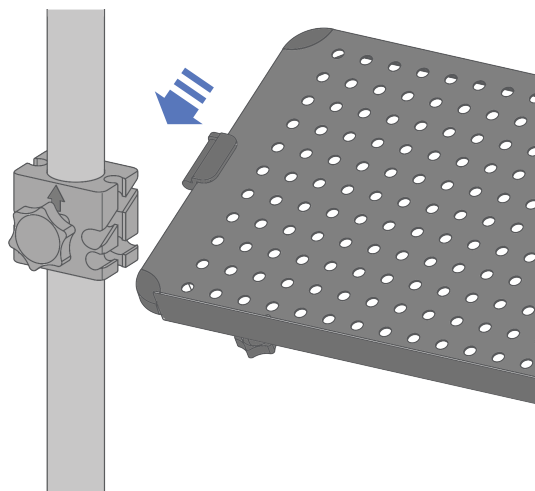

5

Ensure Shelves are Level

Adjust the hubs as needed to ensure shelves are aligned at the same height on both sides.



6

Attach Cross Bars

Clip the cross bar onto the pole and secure into place using the provided screws.

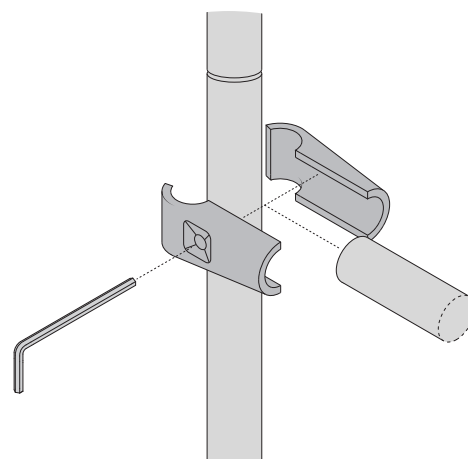

7

Attach TV Mount

Screw the TV Mount to the cross bars using the 1" Thick Screws and the metal washers.

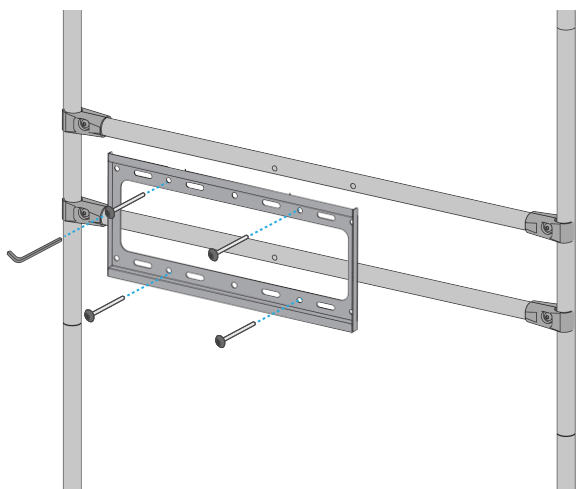

8

Attach Brackets to Monitor

Attach the brackets on your monitor using the 2" TV Bracket Screws.

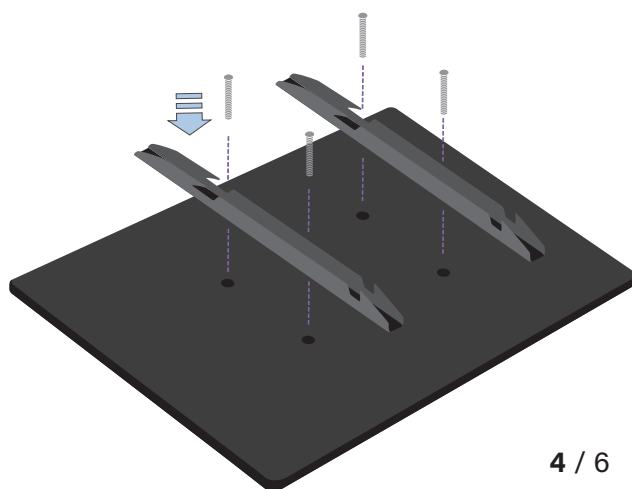

9

Attach Monitor

Attach the monitor bracket hooks to the top of the monitor mount.

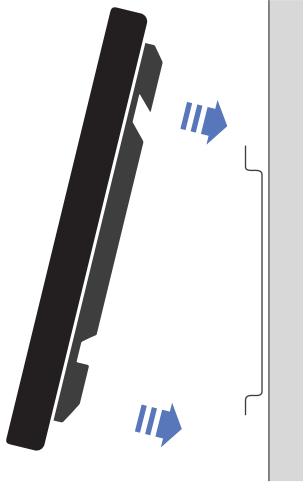
**10**

Secure the Brackets

Insert the 3" Bracket Support Screws into the bottom holes of the brackets in order to safely secure the monitor to the mount.

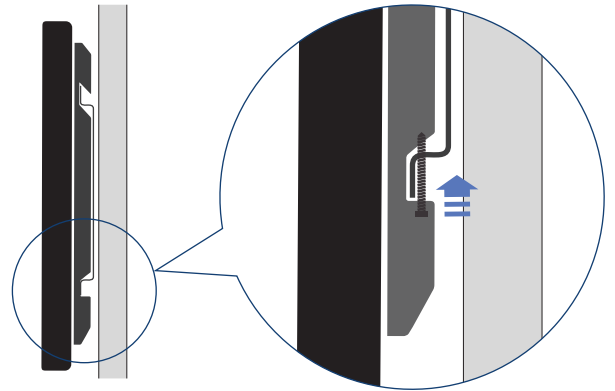

Hardcase / Podium

ASSEMBLY INSTRUCTIONS

BOX CONTENTS

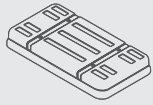

(1) Case Shell A

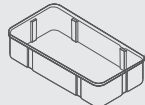

(1) Case Shell B



(1) Counter Top

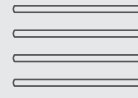

(4) Poles



(1) Podium Graphic
(Ships Separately)

1

Assemble the Frame

Place Case Shell A on the floor and securely insert the poles into the four holes. Then align Case Shell B over the four poles, match up the holes, and fit securely into place.

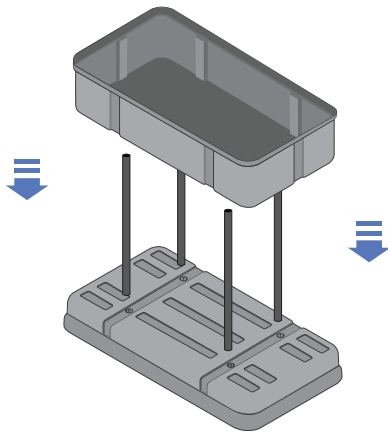

To ensure poles are inserted correctly, twist or firmly press down until they are fully secure.

2

Install the Graphic

Starting at the base, wrap the graphic around Case Shell A and pull up over the top of Case Shell B, one corner at a time. Adjust the graphic so it's straight, then zip the back.

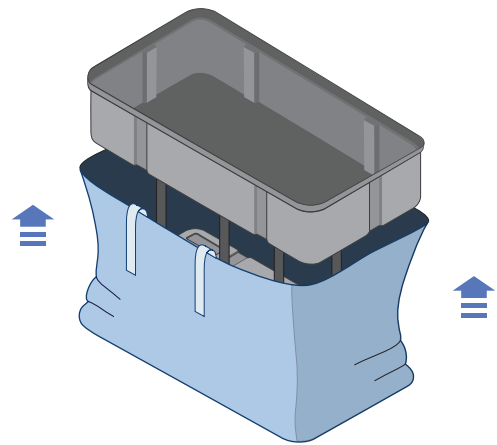

3

Attach the Counter Top

Place the black Counter Top piece on top and press down to ensure the grooves fit over the edges of the case shell.

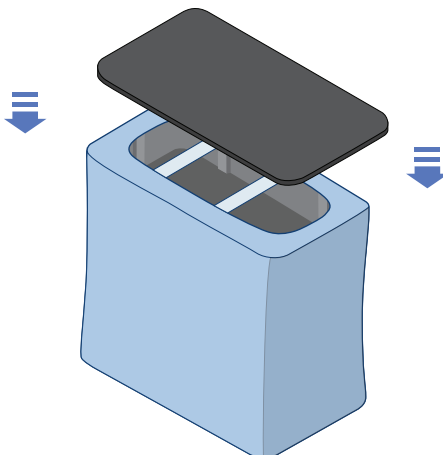

4

Store Personal Items

Hide samples, marketing materials, or personal items inside the podium by storing under the case lid or within the zipper compartment in the back. Your Podium is ready for action!

