

QuickZip™ Supreme Display

ASSEMBLY INSTRUCTIONS

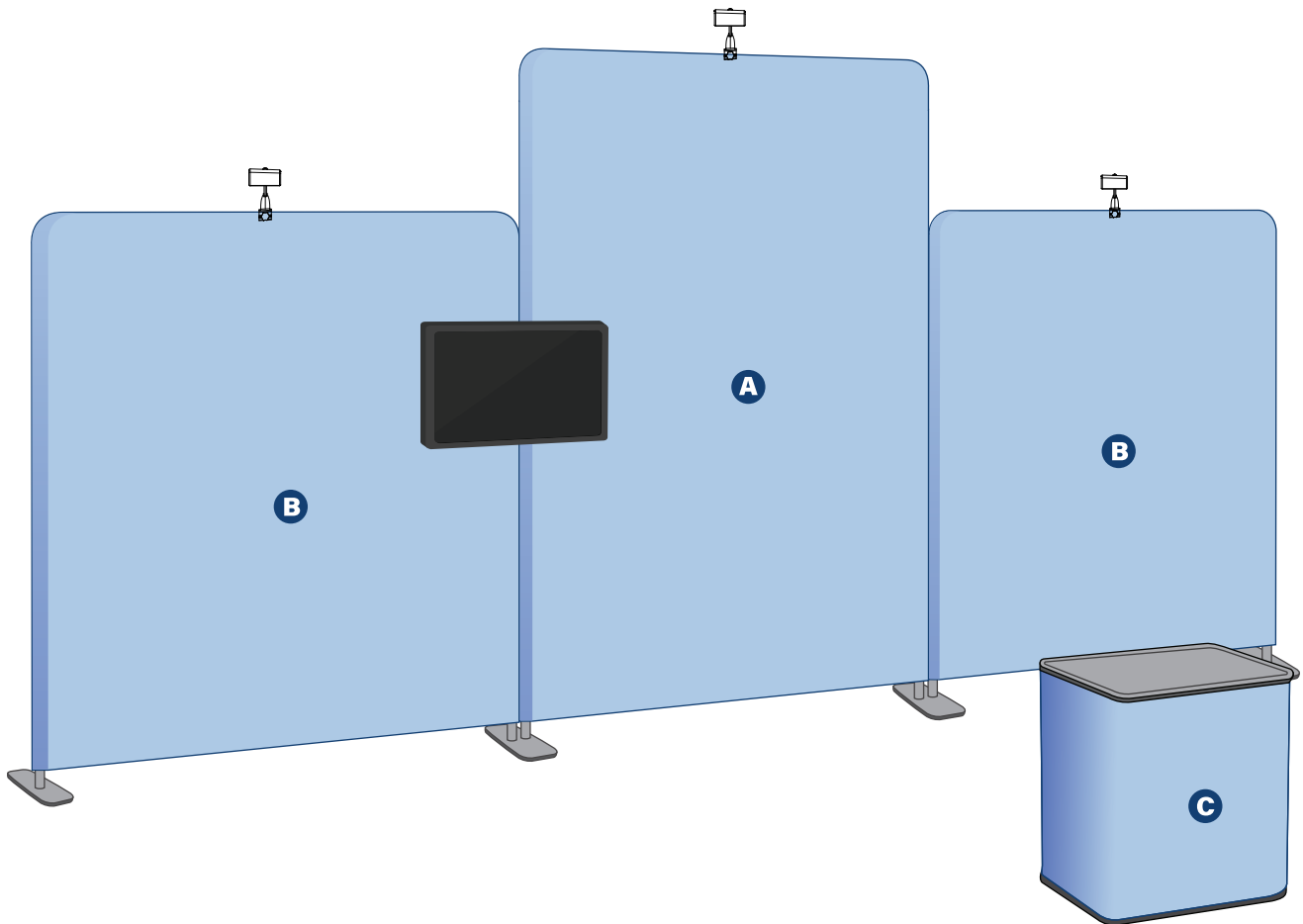

INCLUDED:

- A** QuickZip™ Supreme Center Panel
- B** QuickZip™ Supreme Side Panels
- C** Hardcase Podium

QuickZip™ Supreme Display

ASSEMBLY INSTRUCTIONS

BOX CONTENTS

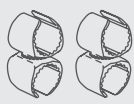

(2) Panel Clamps

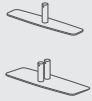

(4) Support Feet

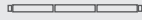

(15) Connected Poles



(3) Light Clips



(6) Bottom Corners

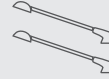

(3) LED Lights



(6) Top Corners



(3) Backdrop Graphics
(Ships Separately)

BOX CONTENTS - TV MOUNT

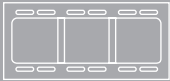

(1) TV Mount



(2) TV Mount
Brackets



(4) M5/M6
Washers



(4) Spacers



(4) M4 x 10mm



(4) M5 x 30mm



(4) M6 x 30mm



(4) M8 x 30mm

NOT FOR USE WITH DISPLAY



(4) Wall Anchors



(4) Wall Anchor
Screws



(4) Washers

1

Assemble the Frame

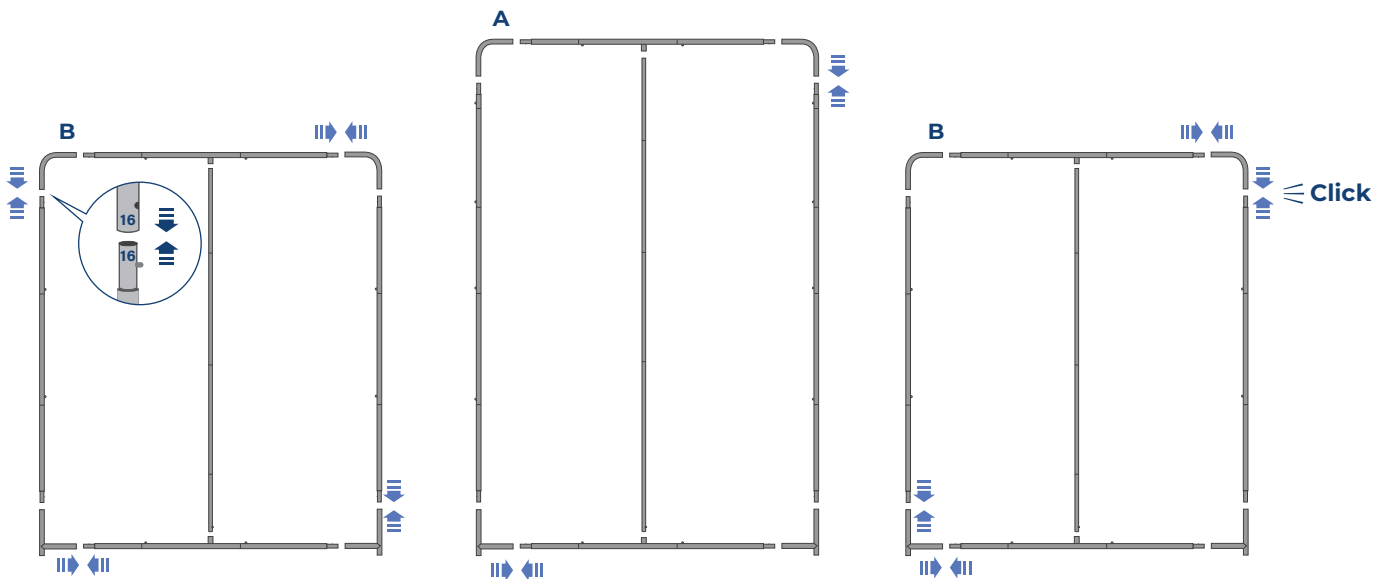

Set up one panel at a time to avoid mixing the Poles

2

Install the Graphics and Attach Feet

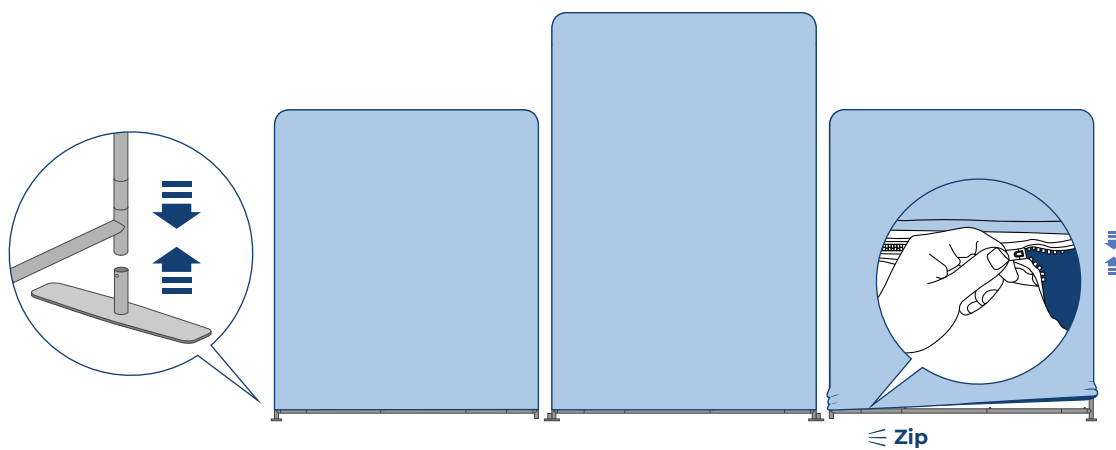

3

Attach LED Lights

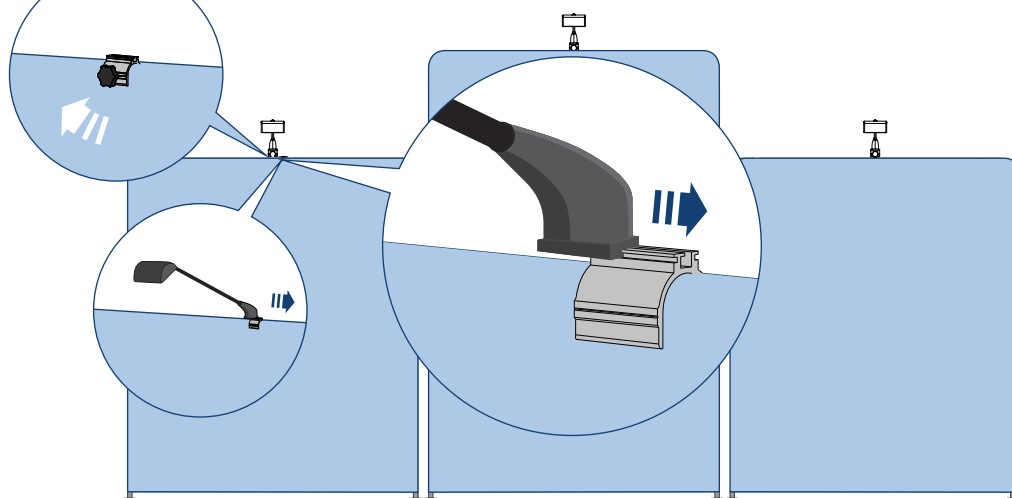

To avoid damage, do not twist the knobs too tight.

4

Connect the Panels

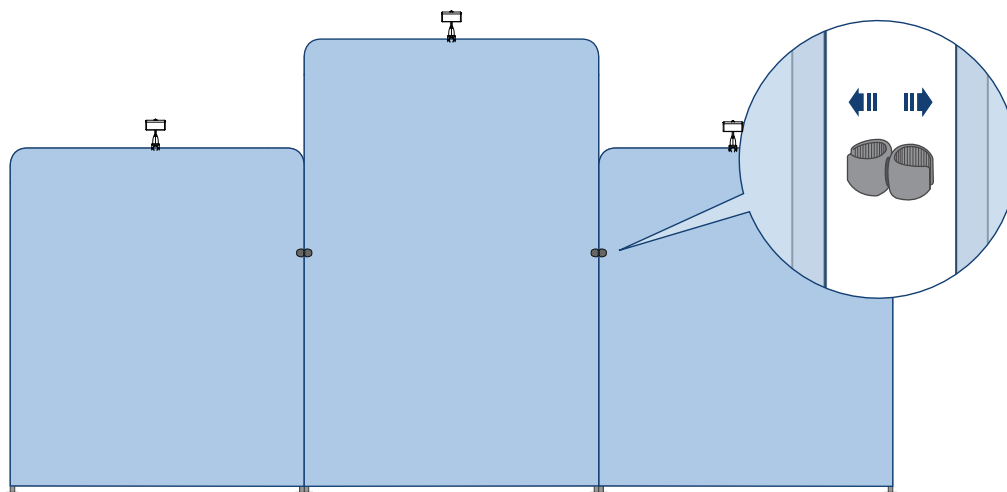

5

Attach TV Mount

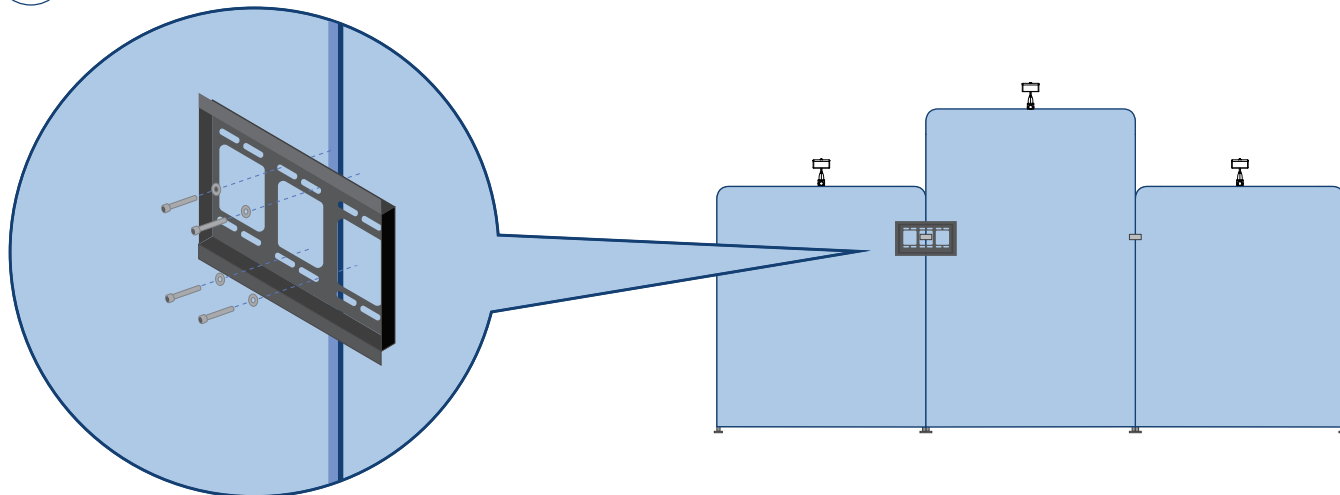

Screw the TV Mount on the display using the M6 Screws and M6 washers.

6

Attach Brackets to Monitor

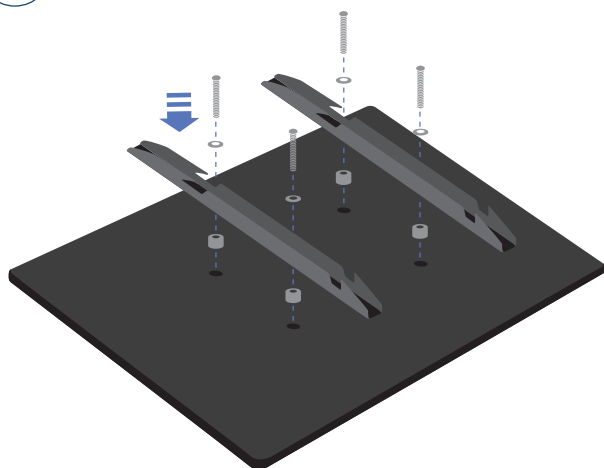

Use the Spacers and M4, M5, or M8 Screws.

7

Mount the Monitor

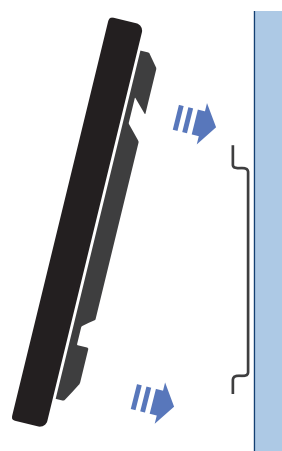

8

Ready to go!

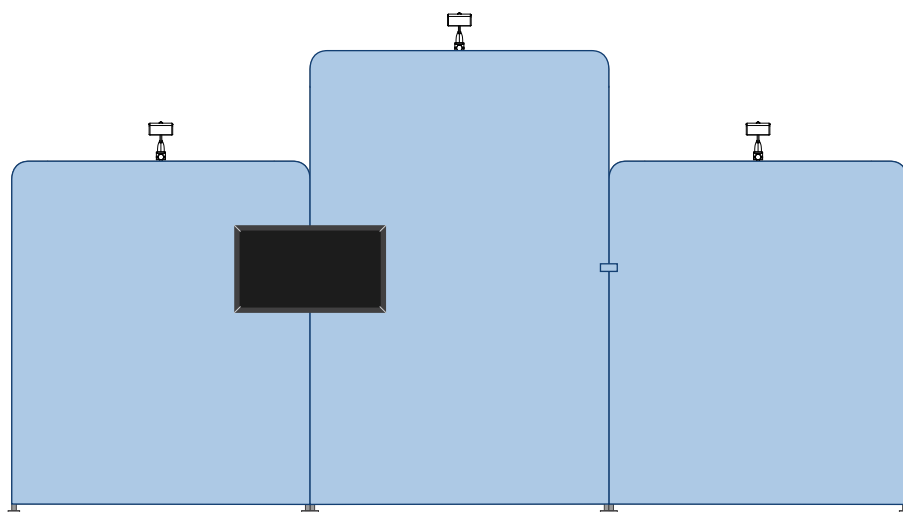



Hardcase / Podium

ASSEMBLY INSTRUCTIONS

BOX CONTENTS

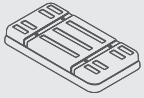

(1) Case Lid

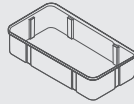

(1) Storage Case



(1) Counter Top

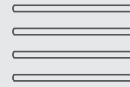

(4) Poles



(1) Podium Graphic
(Ships Separately)

1

Prepare the Base

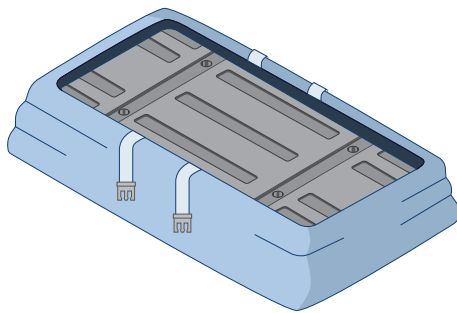

Tuck the bottom end of the Graphic under the Case Lid

2

Set Up the Hardware

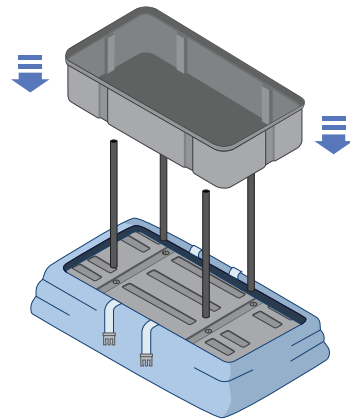

Install the Poles into the Case Lid, then install the Storage Case.

3

Pull Up Graphics

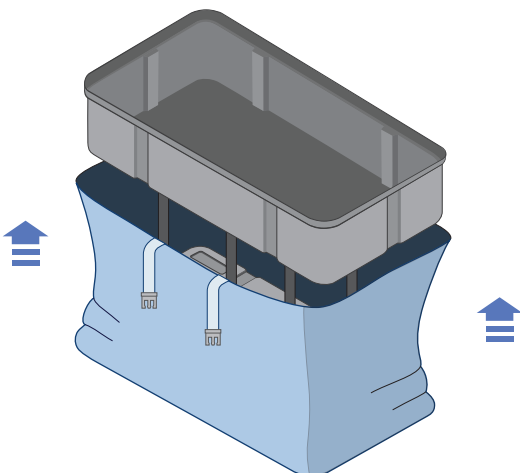

4

Attach the Counter Top

